

Kind of animal and locality	Open season (all dates inclusive)	Limit
(c) Pheasants		
1. Cocks only — In all counties of the state except the properties specified in subd. 2 and s. NR 10.24 and within closed areas established in s. NR 11.14	Beginning on the Saturday nearest October 17 at 12:00 noon and continuing for 54 consecutive days	The bag limit for the first 14 days of the season is one each day with a possession limit of 2; thereafter the bag limit is 2 each day with a possession limit of 4
2. Cocks and hens — Within the following named properties as posted with department signs:	Beginning on the Saturday nearest October 17 at 12:00 noon and continuing for 54 consecutive days	The bag limit for the first 14 days of the season is one each day with a possession limit of 2; thereafter the bag limit is 2 each day with a possession limit of 4
a. Avoca (Iowa county)		
b. Blackhawk (Iowa county)		
c. Collins (Manitowoc county)		
d. Holland (Brown county)		
e. Little Scarboro and Kewaunee (Kewaunee county)		
f. Mazomanie (Dane county)		
g. New Munster (Kenosha county)		
h. Pine River (Richland county)		
i. Theresa (Dodge-Washington counties)		
j. Witwen (Sauk county)		
k. Yellowstone (Lafayette county)		

3. Permit and tag requirement. No person may hunt cock or hen pheasants within the posted areas established in subd. 2. without possessing a current pheasant hunting permit decal, pheasant tags and valid Wisconsin hunting license. Permits and tags are valid only for the year of issue.

4. Permit application procedure. Application forms supplied by the department shall be completed and submitted by the applicant. No person may submit more than one application per year or an application containing false information.

5. Permit and tag issuance procedure. Permits and tags are not transferable or replaceable and may not be reused, altered or defaced. The department shall issue a numbered pheasant hunting permit and 10 tags to each applicant.

6. Permit validation. The numbered pheasant hunting permit decal shall be attached to the applicant's current year Wisconsin hunting license to be valid for use as described in this paragraph. Failure to follow the validation procedure invalidates the permit and tags.

7. Tagging requirement. When a cock or hen pheasant is killed on any lands described in subd. 2 and before it is carried by hand or transported in any manner, the hunter shall completely attach and seal the carcass tag, utilizing its own adhesive, around the leg of the pheasant.

Note: Special rules for the Bong state recreation area are established in s. NR 10.24.

Kind of animal and locality	Open season (all dates inclusive)	Limit
(d) Gray (Hungarian) partridge		
1. In all counties of the state except in the areas listed in subd. 2.	Beginning on the Saturday nearest October 17 at 12:00 noon and continuing through December 31.	Daily bag 3; possession 6
2. Clark, Marathon and Taylor counties.	None	None
(e) Bobwhite quail		
In all counties of the state	Beginning on Saturday nearest October 17 at 12:00 noon and continuing for 54 consecutive days	Daily bag 5; possession 10
(f) Wild turkey (zone hunting)		
1. Zones identified in subd. 2. and Ft. McCoy military reservation in Monroe county are open to turkey hunting by permit. The remainder of the state is closed to turkey hunting.	Spring season beginning on Wednesday nearest April 13 and continuing Wednesday through Sunday for 6 consecutive 5-day time periods, except on Ft. McCoy military reservation where the season may continue for 40 consecutive days.	One male or bearded turkey per season by permit.
2. Hunting zones and permit numbers to be issued for each spring hunting period are:		
Hunting Zones	Permits for each spring period	
1	200	
1A	280	
2	660	
3	900	
4	600	
5	300	
6	300	
7	250	
8	250	
9	175	
10	350	
11	300	
12	200	
13	200	
14	75	
15	150	
30	100	
31	200	
32	150	
Fort McCoy permit numbers are determined by Fort McCoy officials.		

Kind of animal and locality	Open season (all dates inclusive)	Limit
3. Zones 1 and 1A to 5, 9 and 10 as described in s. NR 10.29	Beginning on the Wednesday nearest October 10 and continuing through Sunday for 3 consecutive 5-day time periods	One turkey of either sex per permit per year. Permit numbers are established in subd. 2

c. Permit success rates used to compute the number of permits to be issued for each quota shall be those calculated by the department from annual fisher season harvest reports.

The success rate formula is:

$$\text{Success rate} = \frac{\text{Number of fisher harvested}}{\text{Number of permits issued}}$$

The permit number formula is:

$$\text{Permit number} = \frac{\text{Quota fisher to be harvested}}{\text{Trapper success rate}}$$

d. The overwinter population goal for each management zone is one fisher per 4 square miles of fisher range.

3. Tagging procedure. a. Each person shall immediately upon possessing a fisher or an otter, attach and lock a valid tag, issued by the department, through the opening of the mouth to the opening of the eye, immediately beneath the skin.

b. No person may have a fisher or an otter pelt in possession or under control unless the person trapping the animal attaches the tag as required by this subdivision.

c. The tag shall remain attached to the pelt until removed by a fur dresser or taxidermist at time of preparation.

4. Fisher exhibition. Unless otherwise authorized by the department, each person who has trapped a fisher shall exhibit the pelt separated from the carcass along with the carcass to an authorized department representative in the county in which the animal was trapped, or in an adjoining county, no later than 5 days after the close of the fisher season. The fisher carcass shall be retained by the department.

5. Otter exhibition. Each person who has trapped an otter shall exhibit each pelt to an authorized department representative in the county in which the animal was trapped, or in an adjoining county, but within the area open to otter trapping, no later than 5 days after the close of the otter season.

6. Registration. The department shall inspect the pelt, attach and lock a registration tag to the head of all lawfully taken and possessed fisher and otter.

7. Possession and transfer restrictions. No person may:

a. Possess raw fisher or otter pelts later than 5 days after the close of the fisher and otter seasons to the opening date of the following fisher and otter seasons without a registration tag attached and locked to the head of the animal.

b. Transfer, give, trade, sell or purchase any fisher or otter pelt without a registration tag being attached and locked to the head of the pelt.

8. Fisher or bobcat intended for mounting. Persons exhibiting fisher under subd. 4. or bobcat under s. NR 10.145 (3) who intend to have the fisher or bobcat mounted by a taxidermist may exhibit the fisher or bobcat to the department for registration in whole carcass condition without

separating the pelt and need not surrender the skinned carcass to the department until after the taxidermist has separated the pelt.

History: 1-2-56; am. (3) (g), Register, August, 1985, No. 356, eff. 9-1-85; r. and recr. (intro.), (1) (n), (2) (b), (3) (d) 2, c. and (3) (e) 7., am. (2) (f) 1. and 2., (3) (e) 2, intro. and d. and 9. e., Register September, 1985, No. 357, eff. 10-1-85; emerg. r. and recr. (1) (g) 1.a., cr. (1) (g) 1. am., eff. 10-19-85; r. and recr. (4) (a) 4., am. (2) (f), Register, January, 1986, No. 361, eff. 2-1-86, except (4) (a) 4. eff. 3-1-86; r. and recr. (1) (b), (g), (1) 2. b. and 5., (tm) 3., am. (1) (u) 1., Register, April, 1986, No. 364, eff. 5-1-86; r. and recr. (3) (g), Register, June, 1986, No. 366, eff. 7-1-86; am. (1) (1) 2. and 3. b., (3) (e) (intro.) and (4) (e) 4., r. and recr. (3) (e) 2. and 6., (3) (em) and (4) (e) 1. b., r. (4) (d) 3. to 5., Register, August, 1986, No. 368, eff. 9-1-86; emerg. r. and recr. (1) (a), (b), (g), (1) 2. b. and 5., (tm) 3. and (u) 1., cr. (1) (e) 3. c., eff. 9-12-86; r. and recr. (3) (e) intro. and 1. to 6., am. (3) (e) 9. e. and (4) (e) 2, intro., Register, October, 1986, No. 370, eff. 11-1-86; r. and recr. (1) (a), (b), (g), (1) 2. b. and 5., (tm) 3., (u) 1., cr. (1) (1) 3. c., Register, January, 1987, No. 373, eff. 2-1-87; am. (2) (f) 1. and r. and recr. (2) (f) 2., Register, February, 1987, No. 374, eff. 3-1-87; cr. (4) (e) 8., Register, March, 1987, No. 375, eff. 4-1-87; r. (1) (q) and (r), r. and recr. (3) (g) and (4) (c), Register, July, No. 379, eff. 8-1-87; emerg. r. (1) (a), r. and recr. (1) (b), (c) 2., (g), (1) 2. b. and 5., (tm) 2., 3. and 4., (u) 1., eff. 9-25-87; am. (2) (f) 1. and 2., (3) (e) 9. e., r. and recr. (3) (h) 1. and (4) (e) 2., cr. (3) (h) 3., Register, October, 1987, No. 382, eff. 11-1-87; r. (1) (a), r. and recr. (1) (b), (c) 2., (g), (1) 2. b. and 5., (tm) 2. to 5., and (u) 1., Register, December, 1987, No. 384, eff. 1-1-88; r. and recr. (2) (f) 2., Register, January, 1988, No. 385, eff. 2-1-88; r. and recr. (4) (b), am. (4) (c), Register, June, 1988, No. 390, eff. 7-1-88; renum. (1) (h) to be NR 10.125 (6), r. (1) (i) to (tm), (3) (e) 7. and 9., am. (1) (u) 1., r. and recr. (2) (b) 2., Register, July, 1988, No. 391, eff. 8-1-88; emerg. cr. (1) (a), r. and recr. (1) (b), (c) and (g) eff. 9-21-88; am. (intro.) and (2) (c) 1., Register, October, 1988, No. 394, eff. 11-1-88. cr. (2) (f) 3., Register, October, 1988, No. 394, eff. 1-1-89; cr. (1) (a), r. and recr. (1) (b), (c) and (g), Register, January, 1989, No. 397, eff. 2-1-89; r. and recr. (2) (f) 1. and 2., Register, March, 1989, No. 399, eff. 4-1-89; am. (3) (e) (intro.), r. (4) (e) 1. d., Register, July, 1989, No. 403, eff. 8-1-89; am. (2) (b) 1., (3) (e) 1, intro. and a., 2, intro., a., b., and c., r. and recr. (2) (d), (4) (dm) and (e) 2. d., renum. (3) (e) 1. d. to be 1. e., cr. (3) (e) 1. d., 2. f., 6. and 7., Register, October, 1989, No. 406, eff. 11-1-89; r. and recr. (2) (f) 1. and 2., Register, January, 1990, No. 409, eff. 2-1-90.

Note: For a complete history of s. NR 10.01 from 1-2-56 through 11-30-73 see the history note following s. NR 10.01 published in November 1973, Register. For a complete history of s. NR 10.01 from 12-1-73 through 7-31-85 see the history note following s. NR 10.01 published in the July, 1985 Register.

NR 10.02 Protected wild animals. The following wild animals are designated protected. No person may take, attempt to take, transport or possess any protected wild animal at any time unless expressly authorized by the department.

- (1) Cougar, badger, moose, elk, wolverine and flying squirrel.
- (2) Endangered or threatened species listed in ch. NR 27.
- (3) White deer (monocolored).
- (4) Woodchuck except as provided in s. 29.24, Stats.
- (5) Prairie chicken, Canada spruce grouse (spruce hen), mourning doves, swans, cranes, bitterns, plovers, kingfishers, cormorants, herons, sandpipers and grebes.
- (6) Eagles, hawks, falcons, and owls except as provided in ch. NR 18.
- (7) Hen pheasants except as expressly provided in this chapter.
- (8) Any other wild bird not specified in this chapter.

History: 1-2-56; am. (2), Register, August, 1956, No. 8, eff. 9-1-56; am. (1), Register, August, 1957, No. 20, eff. 9-1-57; am. (1) and (2), Register, August, 1958, No. 32, eff. 9-1-58; am. (1) emerg. eff. 9-20-58; am. (1), Register, August, 1959, No. 44, eff. 9-1-59; am. (2), cr. (3), Register, September, 1965, No. 117, eff. 10-1-65; am. (2), Register, March, 1966, No. 123, eff. 4-1-66; am. (1), Register, August, 1967, No. 140, eff. 9-1-67; renum. to be NR 10.02; am. (2), Register, June, 1970, No. 174, eff. 7-1-70; am. (1), Register, September, 1972, No. 201, eff. 10-1-72; r. (3), Register, December, 1977, No. 264, eff. 1-1-78; r. and recr. Register, August, 1979, No. 284, eff. 9-1-79; am. (1), Register, September, 1983, No. 333, eff. 10-1-83; am. (1), Register, January, 1990, No. 409, eff. 2-1-90.

Register, January, 1990, No. 409

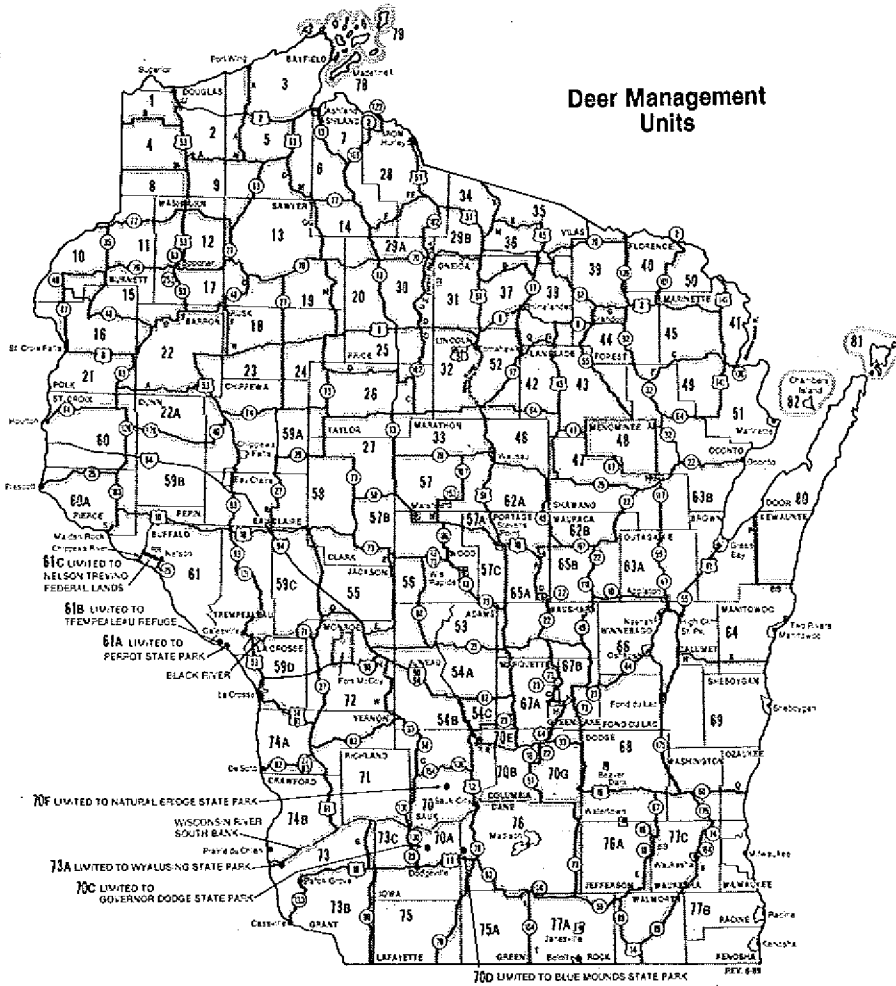

NR 10.29 Wild turkey hunting zones. Wild turkey hunting zones are established as designated on the following map:

History: Cr. Register, November, 1982, No. 323, eff. 12-1-82; r. and recr. Register, March, 1984, No. 339, eff. 4-1-84; r. and recr. Register, March, 1985, No. 351, eff. 4-1-85; r. and recr. Register, October, 1985, No. 358, eff. 11-1-85; r. and recr., Register, October, 1987, No. 382, eff. 11-1-87; r. and recr. Register, January, 1988, No. 385, eff. 2-1-88; r. and recr. Register, March, 1989, No. 399, eff. 4-1-89; r. and recr. Register, January, 1990, No. 409, eff. 2-1-90.

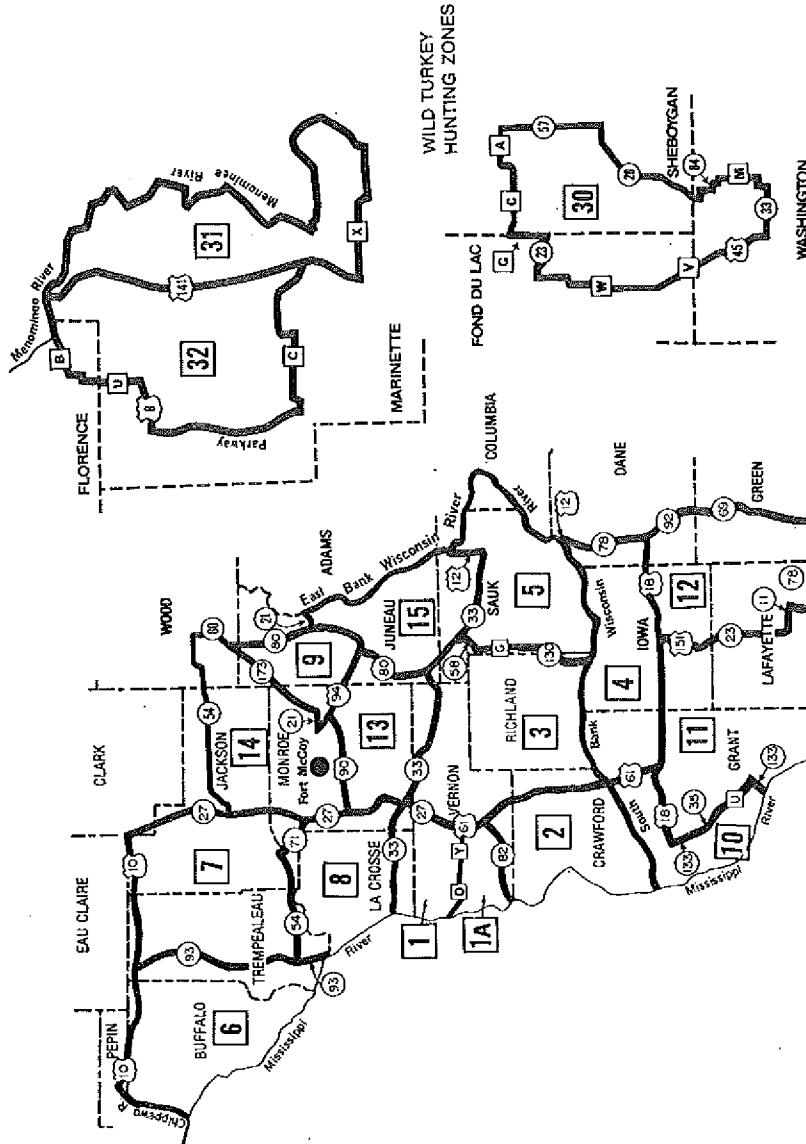

(7) NEW AUBURN SUBZONE.

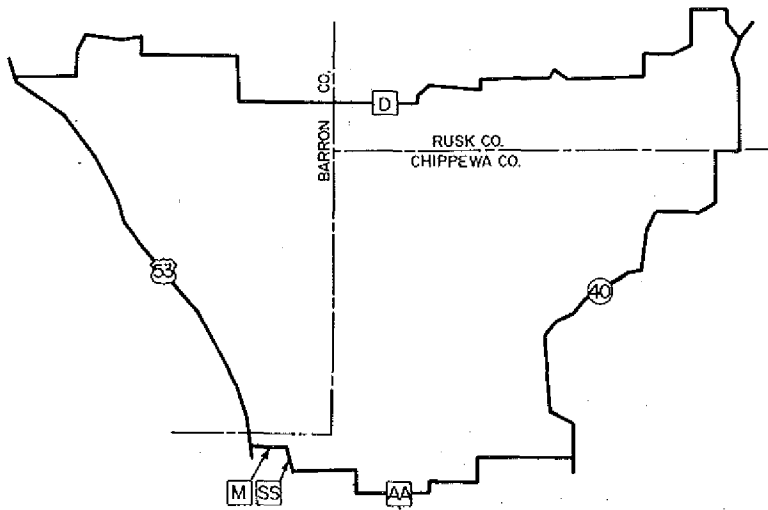

(8) PINE ISLAND ZONE.

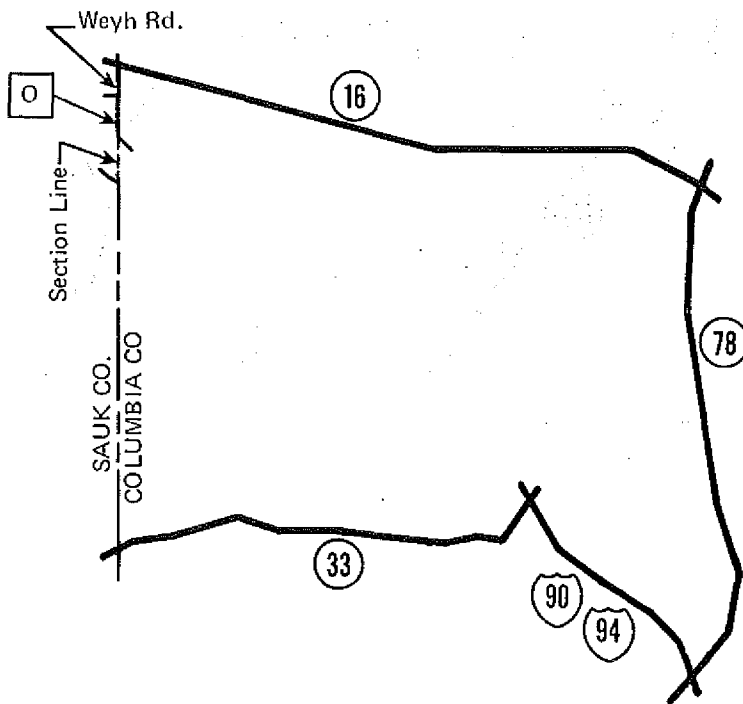

(9) ROCK PRAIRIE ZONE.

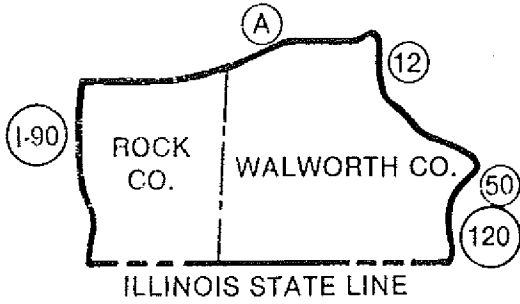

(10) THERESA ZONE.

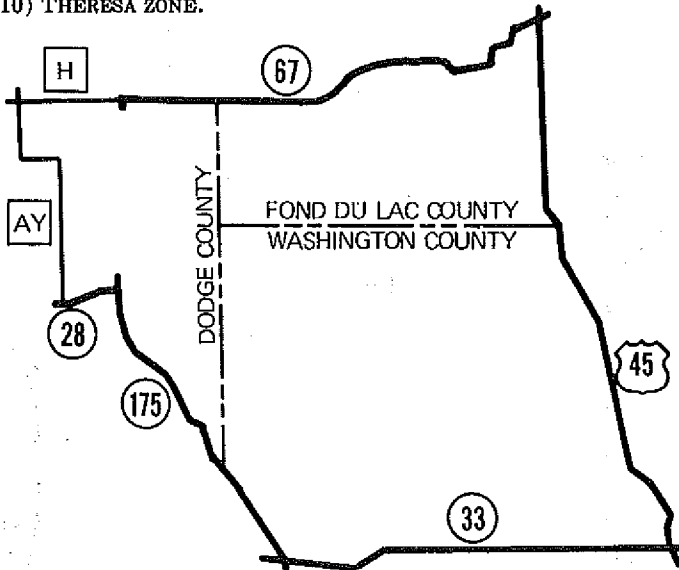

History: Cr. Register, July, 1988, No. 391, eff. 8-1-88; r. and recr. (7), Register, October, 1989, No. 406, eff. 11-1-89.