



(FORM UPDATED: 08/11/2010)

**WISCONSIN STATE LEGISLATURE ...  
PUBLIC HEARING - COMMITTEE RECORDS**

**2009-10**

(session year)

**Joint**

(Assembly, Senate or Joint)

**Committee for Review of Administrative Rules ...**

**COMMITTEE NOTICES ...**

- Committee Reports ... **CR**
- Executive Sessions ... **ES**
- Public Hearings ... **PH**

**INFORMATION COLLECTED BY COMMITTEE FOR AND AGAINST PROPOSAL**

- Appointments ... **Appt** (w/Record of Comm. Proceedings)
- Clearinghouse Rules ... **CRule** (w/Record of Comm. Proceedings)
- Hearing Records ... bills and resolutions (w/Record of Comm. Proceedings)
  - (**ab** = Assembly Bill)                      (**ar** = Assembly Resolution)                      (**ajr** = Assembly Joint Resolution)
  - (**sb** = Senate Bill)                              (**sr** = Senate Resolution)                              (**sjr** = Senate Joint Resolution)
- Miscellaneous ... **Misc**

# Chapter ATCP 50

## Appendix A



### Application for Soil Testing Laboratory Certification

Wis. Stats. s. 92.05(3)(k) and Wis. Adm. Code s. ATCP 50.50

Mail Application to:

Wisconsin Department of Agriculture, Trade and Consumer Protection  
Division of Agricultural Resource Management – Nutrient Management  
PO Box 8911, Madison WI 53708-8911

For Office Use Only

Certification No. \_\_\_\_\_

Date Issued \_\_\_\_\_

Personal information on this application may be used for purposes other than laboratory certification (Wis. Stats. s. 15.04(1)(m)).

#### 1. Applicant (Laboratory Operator):

Legal Name: \_\_\_\_\_

Business Form (Check One):

- Individual  
  Corporation  
  Partnership  
  Cooperative  
  LLC  
  LLP  
 Other \_\_\_\_\_

State of Formation (if other than individual): \_\_\_\_\_

Trade Name (if different from legal name): \_\_\_\_\_

#### 2. Laboratory:

Laboratory Administrator (Name of Individual): \_\_\_\_\_

Mailing Address: \_\_\_\_\_ State: \_\_\_\_\_ Zip: \_\_\_\_\_

Telephone Number: (\_\_\_\_) \_\_\_\_\_ Fax Number (\_\_\_\_) \_\_\_\_\_

#### 3. Soil Tests and Services that the Laboratory Can Provide (Check All that Apply):

REQUIRED FOR CERTIFICATION:

- Soil pH  
  Buffer pH  
  Phosphorus(P)  
  Potassium(K)  
  Organic Matter(OM)  
 Nutrient Recommendations (N, P, K)  
 Lime Recommendations

OTHER TESTS AND SERVICES:

- Other Plant Nutrient Tests  
 Manure Analysis  
 Other Tests or Services

#### 4. Laboratory Qualification to Perform Required Tests:

The applicant certifies that the laboratory is qualified and able to perform all soil tests required for certification (see 3. above), and performs those tests according to applicable standards and methods specified in the following publications:

- a. *Nutrient Application Guidelines for Field, Vegetable and Fruit Crops, UW-Extension Publication A2809 (2006).*
- b. *Wisconsin Procedures for Soil Testing, Plant Analysis and Feed & Forage Analysis, Department of Soil Science, University of Wisconsin-Madison (December, 2007).* A copy can be found at the following web address:  
<http://www.datcp.state.wi.us/arm/agriculture/land-water/conservation/nutrient-mngmt/planning.jsp>

**5. Certification Conditions:**

The applicant agrees to the following certification conditions (failure to comply may result in de-certification):

- a. The laboratory will comply with applicable requirements in Wis. Adm. Code ch. ATCP 50, including ss. ATCP 50.50(4) to (6) related to nutrient recommendations, laboratory records and laboratory evaluation.
- b. Twice each year, in February and August, the laboratory will analyze check samples provided by the University of Wisconsin Soil and Plant Forage Analysis Laboratories (SPAL). The laboratory will assume all costs of the analyses. The laboratory will analyze the SPAL check samples for soil pH, buffer pH, phosphorus (P), potassium (K), and organic matter (OM). The laboratory may also submit additional soil test analysis for Ca, Mg, B, Mn, Zn, SO<sub>4</sub>-S, and NO<sub>3</sub>-N with required semi annual check sample results, but is not required to do so. Based on these analyses, and other information provided by SPAL, the laboratory will report all of the following to SPAL within the time period set by SPAL:
  - Test results for soil pH, buffer pH, phosphorus (P), potassium (K) and organic matter (OM).
  - Lime and nutrient recommendations (N, P, K) according to 4. above.
  - The laboratory may also submit additional soil test results for Ca, Mg, B, Mn, Zn, SO<sub>4</sub>-S, and NO<sub>3</sub>-N with required semi annual check sample results, but is not required to do so.
- c. At least 66% of the check sample results under par. b. must be within one standard deviation of the mean, and at least 40% of the check sample results for each parameter must be within one standard deviation of the mean.
- d. Each month, except in January, February and August, the laboratory will submit 5-10 of its own soil samples to SPAL, together with the results of its tests on those samples. Test results will include soil pH, buffer pH, phosphorus (P), potassium (K) and organic matter (OM). The laboratory may submit results for other plant nutrient tests, but is not required to do so. SPAL will analyze the samples and provide the laboratory with SPAL's test results for comparison.
- e. Laboratory staff will attend educational soil testing meetings sponsored by SPAL.
- f. SPAL representatives may visit the laboratory, and review laboratory procedures, as SPAL deems necessary. SPAL may send double blind soil samples to the laboratory, under the name of another lab client, to evaluate the accuracy of the laboratory's test results and recommendations. The laboratory will waive the cost of analyzing the double blind samples, if SPAL requests a waiver.
- g. The laboratory will submit periodic reports to SPAL, summarizing the results of all soil tests conducted by the laboratory since the end of the period covered by the last periodic report. The laboratory will submit the reports in a format, and according to a schedule, specified by SPAL. SPAL may include the soil test data in its statewide summary of soil test data.
- h. Upon request, the laboratory will make available to SPAL and the Department of Agriculture, Trade and Consumer Protection, for inspection and copying by SPAL or DATCP, copies of all test records that the laboratory is required to keep under Wis. Adm. Code s. ATCP 50.50(5).

The applicant certifies that all information contained in this application is true, correct, and complete.

SIGNATURE OF APPLICANT OR AUTHORIZED REPRESENTATIVE	TITLE	DATE
<p align="center"><b>Recommendation of the UW Diagnostic Services Committee</b></p>	<b>Action By DATCP</b>	
	This request is <input type="checkbox"/> approved <input type="checkbox"/> disapproved (see attachment)	
Date and Authorized Signature	Date and Authorized Signature	

If you have any questions regarding this application, contact Sue Porter at (608) 224-4605.

# Chapter ATCP 50

## Appendix G

### Technical Standards Incorporated by Reference

Chapter ATCP 50, Wis. Adm. Code, incorporates the following technical standards by reference. *Primary standards* are specifically identified in ATCP 50. *Secondary standards* are incorporated by reference in one or more primary standards. The following list identifies each primary and secondary standard and its date of publication. Copies of each standard are on file with the department and the legislative reference bureau. The county land conservation committee normally has inspection copies on file. The following list explains how to obtain copies from the publisher. Future updates to technical standards are *not* automatically incorporated into ATCP 50. The department may incorporate future updates in future rule amendments.

#### Primary Standards

1. ***United States Department of Agriculture, Natural Resources Conservation Service, Wisconsin, Section IV, Technical Guide (“NRCS technical guide”) standards.*** A person may obtain copies of the following standards from the NRCS Wisconsin State Office, 8030 Excelsior Drive, Suite 200, Madison WI 53717-2906. Phone: 608-276-8732. Website: [www.nrcs.usda.gov](http://www.nrcs.usda.gov).
  - Access Road Standard 560 (August, 2006).
  - Animal Trails and Walkways Standard 575 (August, 2006).
  - Channel Stabilization Standard 584 (July, 2003).
  - Closure of Waste Impoundments Standard 360 (November, 2006).
  - Contour Farming Standard 330 (May, 2002).
  - Cover Crop Standard 340 (June, 2002).
  - Critical Area Planting Standard 342 (June, 2002).
  - Diversion Standard 362 (August, 2006).
  - Fence Standard 382 (November, 1999).
  - Field Border Standard 386 (May, 2002).
  - Filter Strip Standard 393 (January, 2001).
  - Fish Passage Standard 396 (June, 2008).
  - Grade Stabilization Structure Standard 410 (July, 2001).
  - Grassed Waterway Standard 412 (June, 2008).
  - Heavy Use Area Protection Standard 561 (August, 2008).
  - Irrigation Regulating Reservoir Standard 552 (May, 2004).
  - Irrigation System, Sprinkler Standard 442 (May, 2004).
  - Irrigation System, Tailwater Recovery Standard 447 (June, 2008).
  - Irrigation Water Conveyance Aluminum Tubing Pipeline Standard 430AA (May, 2004).
  - Irrigation Water Conveyance High-Pressure, Underground, Plastic Pipeline Standard 430DD (May, 2004).
  - Irrigation Water Management Standard 449 (May, 2004).
  - Lined Waterway or Outlet Standard 468 (August, 2006).
  - Manure Transfer Standard 634 (February, 2007).
  - Mulching Standard 484 (June, 2002).
  - Nutrient Management Standard 590 (September, 2005).
  - Obstruction Removal Standard 500 (May, 2002).
  - Open Channel Standard 582 (May, 2002).

- Pasture and Hayland Planting Standard 512 (June, 2002).
- Pest Management Standard 595 (June, 2003).
- Pipeline Standard 516 (April, 2002).
- Pond Standard 378 (July, 2001).
- Pond Sealing or Lining, Flexible Membrane Lining Standard 521A (March, 2008).
- Pond Sealing or Lining-Bentonite Treatment Standard 521C (October, 2007).
- Prescribed Grazing (Managed Grazing-Wisconsin) Standard 528 (December, 2005).
- Pumping Plant Standard 533 (July, 2003).
- Recreation Trail and Walkway Standard 568 (October, 2007).
- Residue and Tillage Management-No Till/Strip Till/Direct Seed Standard 329 (October, 2006).
- Residue and Tillage Management-Mulch Till Standard 345 (October, 2006).
- Residue Management- Seasonal Standard 344 (October, 2006).
- Riparian Forest Buffer Standard 391 (January, 2001).
- Roof Runoff Structure Standard 558 (January, 2008).
- Sediment Basin Standard 350 (August, 2008).
- Shoreland Habitat Standard 643A (July, 2001).
- Sinkhole Treatment Standard 725 (March, 2000).
- Spoil Spreading Standard 572 (May, 2002).
- Spring Development Standard 574 (June, 2008).
- Streambank and Shoreline Protection Standard 580 (December, 2005).
- Stripcropping Standard 585 (June, 2002).
- Structure for Water Control Standard 587 (June, 2002).
- Subsurface Drain Standard 606 (June, 2002).
- Surface Drainage, Field Ditch Standard 607 (June, 2003).
- Surface Drainage, Main or Lateral Standard 608 (August, 2006).
- Terrace Standard 600 (June, 2002).
- Tree/Shrub Establishment Standard 612 (April, 2003).
- Underground Outlet Standard 620 (May, 2002).
- Use Exclusion Standard 472 (June, 2002).
- Vegetated Treatment Area Standard 635 (August, 2008).
- Waste Storage Facility Standard 313 (December, 2005).
- Waste Treatment Standard 629 (August, 2008).
- Water & Sediment Control Basin Standard 638 (July, 2001).
- Watering Facility Standard 614 (April, 2002).
- Water Well Standard 642 (May, 2005).
- Well Decommissioning Standard 351 (May, 2008).
- Wetland Restoration Standard 657 (September, 2000).
- Wildlife Upland Habitat Management Standard 645 (July, 2000).
- Windbreak/Shelterbelt Establishment Standard 380 (June, 2002).

2. **University of Wisconsin-Extension Publications.** A person may obtain copies of the following standards from Cooperative Extension Publications, 45 North Charter Street, Madison WI 53715. Phone: 877-WIS-PUBS (947-7827). E-mail: [reitzman@admin.uwex.edu](mailto:reitzman@admin.uwex.edu)

- Nutrient application guidelines for field, vegetable, and fruit crops in Wisconsin, UWEX Pub. No. A2809 (2006).
- Soil Test Recommendations for Field, Vegetable and Fruit Crops, UWEX Pub. No. A-2809 (1998).
- Pollution Control Guide for Milking Center Waste Water Management, UWEX Pub. No. A3592 (1994).
- Pastures for profit: A guide to rotational grazing, UWEX Pub. No. A3529 (2002).

- Recommended Methods of Manure Analysis, UWEX Pub. No. A3769 (2003).
3. **Wisconsin Department of Natural Resources Standards.** A person may obtain these standards from the Wisconsin Department of Administration, Document Sales Unit, 202 S Thornton Ave, PO Box 7840, Madison WI 53707-7840. Phone: 608-266-3358. E-mail: [docsales@doa.state.wi.us](mailto:docsales@doa.state.wi.us).
    - Wet Detention Basin Standard 1001 (June, 1999).
    - “Wisconsin Construction Site Best Management Practice Handbook”, DNR Publication No. WR-222 93 (April 1994).
  4. **United States Department of Agriculture, Natural Resources Conservation Service-Wisconsin.**
    - Wisconsin Conservation Planning Technical Note WI-1, “Companion Document to NRCS FOTG Standard 590, Nutrient Management”. (September, 2007). A person may obtain copies of this standard from the NRCS Wisconsin State Office, 8030 Excelsior Drive, Suite 200, Madison, WI 53717-2906. Phone: 608-276-8732. Website: [www.nrcs.usda.gov](http://www.nrcs.usda.gov).
    - Revised Universal Soil Loss Equation, Version 2 (“RUSLE 2”), (November 14, 2006). This software contains 9 previous versions as well as the 2006 version and may be downloaded free of charge from: [http://fargo.nserl.purdue.edu/rusle2\\_dataweb/RUSLE2\\_Index.htm](http://fargo.nserl.purdue.edu/rusle2_dataweb/RUSLE2_Index.htm)
  5. **American Society of Civil Engineers (ASCE), Minimum Design Loads for Buildings and Other Structures, ASCE/SEI 7-05 (2006).** A person may obtain this standard from ASCE Publications, 1801 Alexander Bell Drive, Reston, VA 20191. Phone: 800-548-ASCE (2723). Email: [www.asce.org/asce.cfm](http://www.asce.org/asce.cfm).
  6. **University of Wisconsin-Madison, Biological Systems Engineering Department.** Wisconsin Minimum Design and Construction Standards for Concrete Mixing and Loading Pads and Secondary Containment Structures (February, 2005). A person may obtain this standard from the Biological Systems Engineering Dept., University of Wisconsin-Madison, 460 Henry Mall, Madison WI 53706. Phone: 608-262-3311. E-mail: [hkirschn@facstaff.wisc.edu](mailto:hkirschn@facstaff.wisc.edu)
  7. **University of Wisconsin-Madison, Soil Science Department.** Wisconsin Procedures for Soil Testing, Plant Analysis and Feed & Forage Analysis (December 2007). A person may obtain this standard from the Soil Science Department, University of Wisconsin-Madison, Madison, WI 53706, or from this department’s website: <http://www.datcp.state.wi.us/arm/agriculture/land-water/conservation/nutrient-mngmt/planning.jsp>.

## Secondary Standards

1. **United States Department of Agriculture, Natural Resources Conservation Service – Wisconsin, Section IV, Technical Guide (“NRCS technical guide”).** A person may obtain copies of the following standards from the NRCS Wisconsin State Office, 8030 Excelsior Drive, Suite 200, Madison WI 53717-2906. Phone: 608-276-8732. Website: [www.nrcs.usda.gov](http://www.nrcs.usda.gov).
  - Conservation Crop Rotation Standard 328 (May, 2002).
  - Forest Site Preparation Standard 490 (June, 2002).
  - Stream Crossing Standard 578 (August, 2006).
  - Stream Habitat Improvement and Management Standard 395 (May, 2006).
  - Hedgerow Planting Standard 422 (June, 2002).
  - Prescribed Burning Standard 338 (March, 2008).
  - Wildlife Watering Facilities Standard 648 (October, 1991).

- Wisconsin Construction Specification 2, "Excavation" (July, 2008).
  - Wisconsin Construction Specification 3, "Earthfill" (June, 2005).
  - Wisconsin Construction Specification 4, "Concrete" (September, 2003).
  - Wisconsin Construction Specification 6, "Corrugated Metal Pipe Conduits" (April, 2006).
  - Wisconsin Construction Specification 9, "Rock Riprap" (July, 2008).
  - Wisconsin Construction Specification 10, "Fences" (June, 2002).
  - Wisconsin Construction Specification 13, "Geotextiles" (May, 2008).
  - Wisconsin Construction Specification 15, "Plastic Pipe Conduits" (January, 2006).
  - Wisconsin Construction Specification 19, "Well Abandonment/Decommissioning" (May, 2006).
  - Wisconsin Construction Specification 202 "Polyethylene Geomembrane Lining" (December, 2005).
  - Wisconsin Construction Specification 203 "Geosynthetic Clay Liner" (March, 2005).
  - Wisconsin Construction Specification 204 "Earthfill for Waste Storage Facilities" (March, 2005).
  - Wisconsin Construction Specification 205 "Flexible Membrane Lining" (April, 1999).
  - Wisconsin Construction Specification 300 "Clay Liner" (December, 2005).
2. **United States Department of Agriculture, Natural Resources Conservation Service, Agricultural Waste Management Field Handbook, Part 651.** A person may obtain copies of the following standards from the NRCS Wisconsin State Office, 8030 Excelsior Drive, Suite 200, Madison WI 53717-2906. Phone: 608-276-8732. Website: [www.nrcs.usda.gov](http://www.nrcs.usda.gov).
- Chapter 7, "Geologic and Ground Water Considerations" (June, 1999).
  - Chapter 9, "Agricultural Waste Management Systems" (April, 1992).
  - Chapter 10, "Agricultural Waste Management System Component Design" (July, 1996).
  - Chapter 12, "Waste Management Equipment" (October, 1997).
3. **United States Department of Agriculture, Natural Resources Conservation Service – Wisconsin, Wisconsin Technical Notes.** A person may obtain copies of the following standards from the NRCS Wisconsin State Office, 8030 Excelsior Drive, Suite, Madison WI 53717-2906. Phone: 608-276-8732. Website: [www.nrcs.usda.gov](http://www.nrcs.usda.gov).
- Wisconsin Agronomy Technical note WI-1, "Guidelines for Herbaceous Stand Evaluation" (May, 1991).
  - Wisconsin Agronomy Technical Note WI-5, "Prairie Restoration Seeding" (September, 1999).
  - Wisconsin Biology Technical Note 1, "Shoreland Habitat" (September, 2001).
  - Wisconsin Forestry Technical Note WI-1, "Native Tree and Shrub Planting Recommendations for Wisconsin" (April, 2003).
  - Wisconsin Forestry Technical Note WI-2, "Tree and Shrub Establishment" (April, 2003).
4. **United States Department of Agriculture, Natural Resources Conservation Service.** A person may obtain copies of the following standards from the NRCS Wisconsin State Office, 8030 Excelsior Drive, Suite 200, Madison WI 53717-2906. Phone: 608-276-8732. Website: [www.nrcs.usda.gov](http://www.nrcs.usda.gov).
- Technical Release TR-25, "Design of Open Channels" (1977).
  - Technical Release TR-55, "Urban Hydrology for Small Watersheds" (June, 1986).
  - Technical Release TR-60, "Earth Dams and Reservoirs" (July, 2005).
  - Field Office Technical Guide, Section III, "Guidelines for Resource Management System Quality Criteria and Human Considerations" (March, 2005).
  - Field Office Technical Guide, Section I, Part II, "Wind Erosion Prediction" (February, 2003).

- National Planning Procedures Handbook, Subpart F, Part 600.75, “Draft Comprehensive Nutrient Management Planning Technical Guidance” (undated, the version in effect in 2008).
  - National Handbook of Conservation Practices, Standard 554, “Drainage Water Management” (September, 2001).
  - Wisconsin Job Sheet 134, “How to Establish and Maintain Introduced Grasses and Legumes” (May, 2000).
  - Wisconsin Job Sheet 135, “How to Establish and Maintain Native Grasses, Forbs and Legumes” (May, 2000).
  - Wisconsin Job Sheet 136, “Wildlife Food Plots” (January, 2000).
  - Wisconsin Job Sheet 142, “Permanent Wildlife Habitat” (January, 2000).
  - “Soil Conditioning Index” (June, 2005).
  - “Windows Pesticide Screening Tool” (WIN-PST 3.0) (November 11, 2005). This may also be downloaded from the website: [www.wcc.nrcs.usda.gov/pestmgmt/winpst.html](http://www.wcc.nrcs.usda.gov/pestmgmt/winpst.html).
5. ***United States Department of Agriculture, Natural Resources Conservation Service National Engineering Field Handbook, Part 650.*** A person may obtain copies of the following standards from the NRCS Wisconsin State Office, 8030 Excelsior Drive, Suite 200, Madison WI 53717-2906. Phone: 608-276-8732. Website: [www.nrcs.usda.gov](http://www.nrcs.usda.gov).
- Chapter 6 “Structures” (undated, version in effect on September 1, 2002).
  - Chapter 7, “Grassed Waterways” (1986).
  - Chapter 11, “Ponds and Reservoirs” (April, 1980).
  - Chapter 14, “Water Management (Drainage)” (April, 2001).
  - Chapter 16, “Streambank and Shoreland Protection” (December, 1996).
  - Chapter 18, “Soil Bioengineering for Upland Slope Protection and Erosion Reduction” (October 1992).
6. ***United States Department of Agriculture, Natural Resources Conservation Service National Engineering Field Handbook, Part 631.*** A person may obtain copies of the following standards from the NRCS Wisconsin State Office, 8030 Excelsior Drive, Suite 200, Madison WI 53717-2906. Phone: 608-276-8732. Website: [www.nrcs.usda.gov](http://www.nrcs.usda.gov).
- Chapter 33, “Investigations for Ground Water Resources Development” (November, 1998).
7. ***United States Department of Agriculture, Natural Resources Conservation Service National Engineering Handbook, Part 623.*** A person may obtain copies of the following standards from the NRCS Wisconsin State Office, 8030 Excelsior Drive, Suite 200, Madison WI 53717-2906. Phone: 608-276-8732. Website: [www.nrcs.usda.gov](http://www.nrcs.usda.gov).
- Chapter 2, “Irrigation Water Requirements” (September, 1993).
8. ***United States Department of Agriculture, Natural Resources Conservation Service – Wisconsin, “Drainage Guide for Wisconsin” (1977).*** A person may obtain this standard from the NRCS Wisconsin State Office, 8030 Excelsior Drive, Suite 200, Madison WI 53717-2906. Phone: 608-276-8732. Website: [www.nrcs.usda.gov](http://www.nrcs.usda.gov).
9. ***University of Wisconsin-Extension Publications.*** A person may obtain copies of the following standards from Cooperative Extension Publications, 45 North Charter Street, Madison WI 53715. Phone: 877-WIS-PUBS (947-7827). E-mail: [reitzman@admin.uwex.edu](mailto:reitzman@admin.uwex.edu)
- “Forage Variety Update for Wisconsin, 2007 Trial Results”, UWEX Publication A1525 (2007).



- Training Manual for the Private Pesticide Applicator, 4<sup>th</sup> Edition, Chapter 25 – “Calibration” (January 1998).
  - “Sampling Soils for Testing”, UWEX Publication A2100 (2007).
  - “Phosphorous for Bearing Cranberries in North America” (November, 2004).
10. **Oregon State University-Extension Publications, “Cranberry Tissue Testing for Producing Beds in North America”. Extension Publication Number EM-8610 (August, 1995).** A person may obtain copies of the standard from Extension Service Administration, 101 Ballard Hall, Corvallis, OR 97331-0360 Phone: 541-737-2713 or from the UW Horticulture Department Website: [www.hort.wisc.edu/cran/mgt\\_articles/articles\\_nutr\\_mgt/a3642.pdf](http://www.hort.wisc.edu/cran/mgt_articles/articles_nutr_mgt/a3642.pdf)
11. **Wisconsin Department of Natural Resources Publications.** A person may obtain the following standards from the Wisconsin Department of Administration, Document Sales Unit, 202 S Thornton Ave, PO Box 7840, Madison WI 53707-7840. Phone: 608-266-3358. E-mail: [docsales@doa.state.wi.us](mailto:docsales@doa.state.wi.us).
- BARNY 2.6, “The Wisconsin Barnyard Runoff Model” (October, 1996).
  - “Trails”, Wisconsin Trail Specification Handbook, 8605.1, Ch. 30 (October 2004).
  - “Wisconsin’s Forestry Best Management Practices for Water Quality”, Field Manual Publication No. FR-093 (Reprinted and revised, May, 2003).
12. **Wisconsin Department of Transportation, Facilities Development Manual, Chapter 10, “Erosion Control and Storm Water Quality” (January, 1997).** A person may obtain this standard from the Wisconsin Dept of Transportation, 4802 Sheboygan Avenue, Madison, WI 53707 Phone: 608-266-0724 E-mail: [library@dot.state.wi.us](mailto:library@dot.state.wi.us)
13. **American Concrete Institute Publications.** A person may obtain copies of the following standards from the American Concrete Institute, PO Box 9094, Farmington Hills, MI 48333-9094. Phone: 248-848-3800. Website: [www.aci-int.org](http://www.aci-int.org).
- “Building Code Requirements for Structural Concrete,” ACI 318-02 (January, 2002).
  - “Design of Slabs on Grade,” ACI 360R-92 (Re-approved 1997).
14. **American Forest & Paper Association, American Wood Council, “National Design Specification for Wood Construction” with Supplement (January, 2005).** A person may obtain this standard from the American Forest & Paper Association, 1111 19th St NW, Suite 800, Washington, DC 20036. Phone: 800-890-7732. E-mail: [AWCINFO@afandpa.org](mailto:AWCINFO@afandpa.org).
15. **American Society of Agricultural and Biological Engineers, Engineering Practices.** A person may obtain copies of the following standards from the American Society of Agricultural and Biological Engineers, 2950 Niles Road, St Joseph, MI 49085. Phone: 616-429-0300. Website: [www.asae.org](http://www.asae.org).
- Engineering Practice Number 288.5, “Agricultural Building Snow and Wind Loads” (January, 2001).
  - Engineering Practice Number 378.3, “Floor and Suspended Loads on Agricultural Structures Due to Use” (February, 2004).
  - Engineering Practice Number 393.3, “Manure Storages” (February, 2004).
  - Engineering Practice Number 470, “Manure Storage Safety” (January, 1992; reaffirmed February, 2005).
16. **American Institute of Steel Construction, Inc. “Manual of Steel Construction, Load and Resistance Factor Design,” 3rd edition (November 2001), with Shapes Database compact disc Version 3.0.** A person may obtain this standard from the American Institute of Steel Construction, One East Wacker Drive, Suite 3100, Chicago IL 60601-2001. Phone: 800-644-2400. Website: [www.aisc.org](http://www.aisc.org).

# BROWN COUNTY

Town of Holland

T21N R2E PA 93-05-01

All uses of atrazine are prohibited on lands within the shaded regions. There are three prohibition areas in Brown County, one of which is shared by Manitowoc, Brown and Calumet Counties. Refer to each map for specific locations.

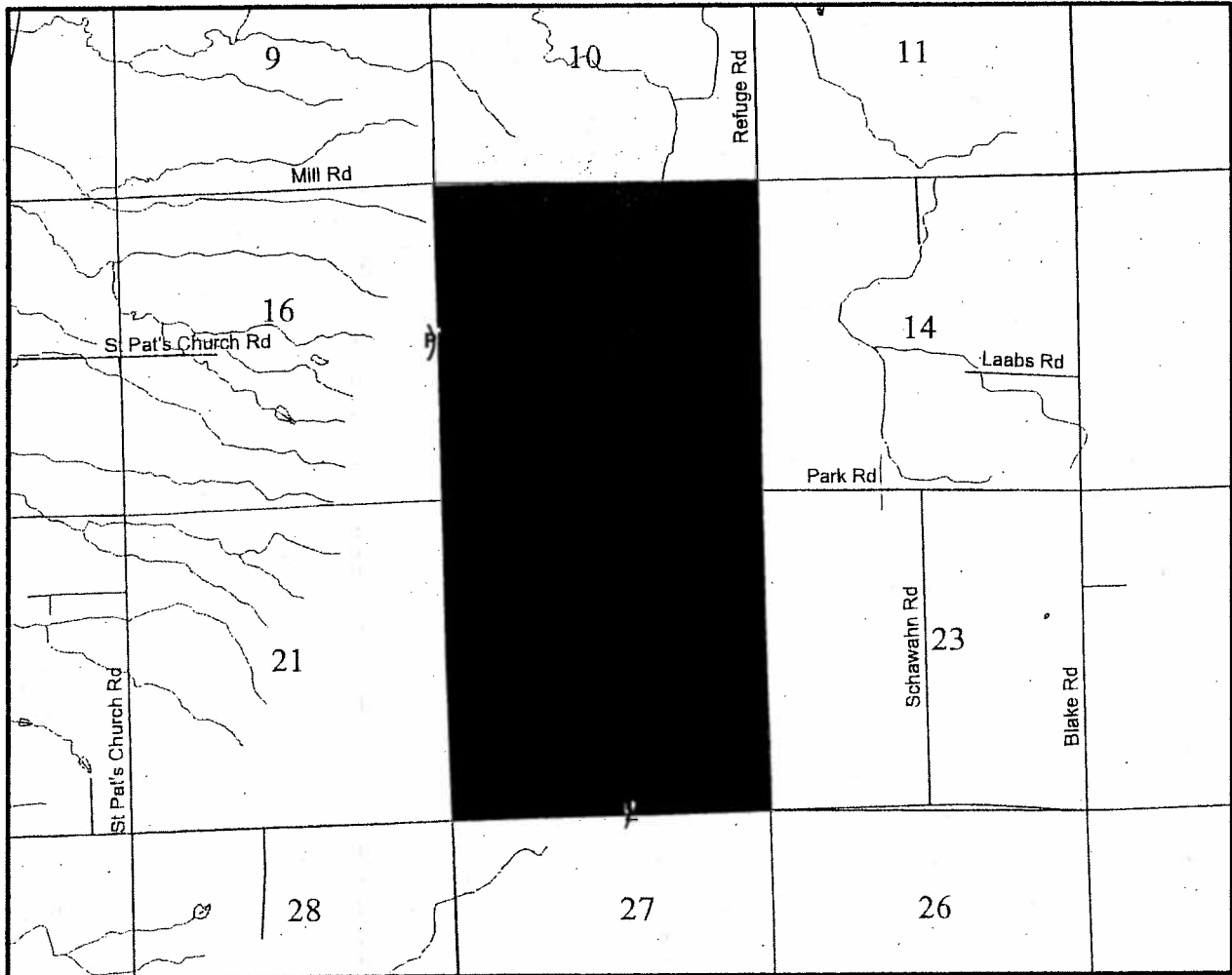
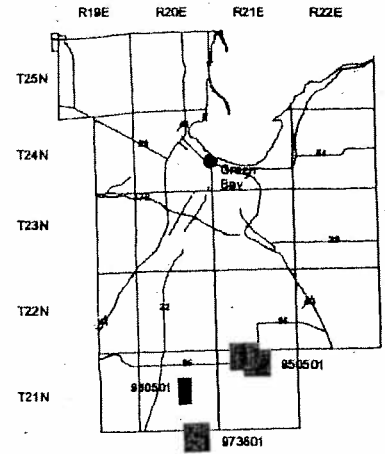

# BROWN COUNTY

Towns of

Morrison and Glenmore

T21N R2E PA 95-05-01\*

All uses of atrazine are prohibited on lands within the shaded regions. There are three prohibition areas in Brown County, one of which is shared by Manitowoc, Brown and Calumet Counties. Refer to each map for specific locations.

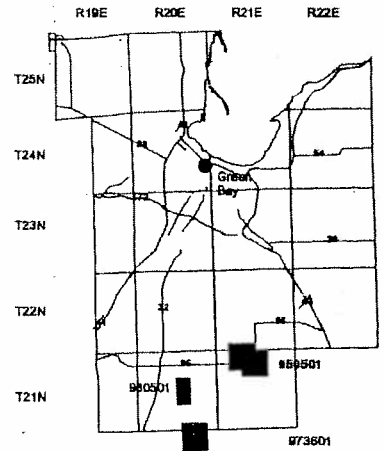

\*Note: This PA is an expansion of PA 93-05-02

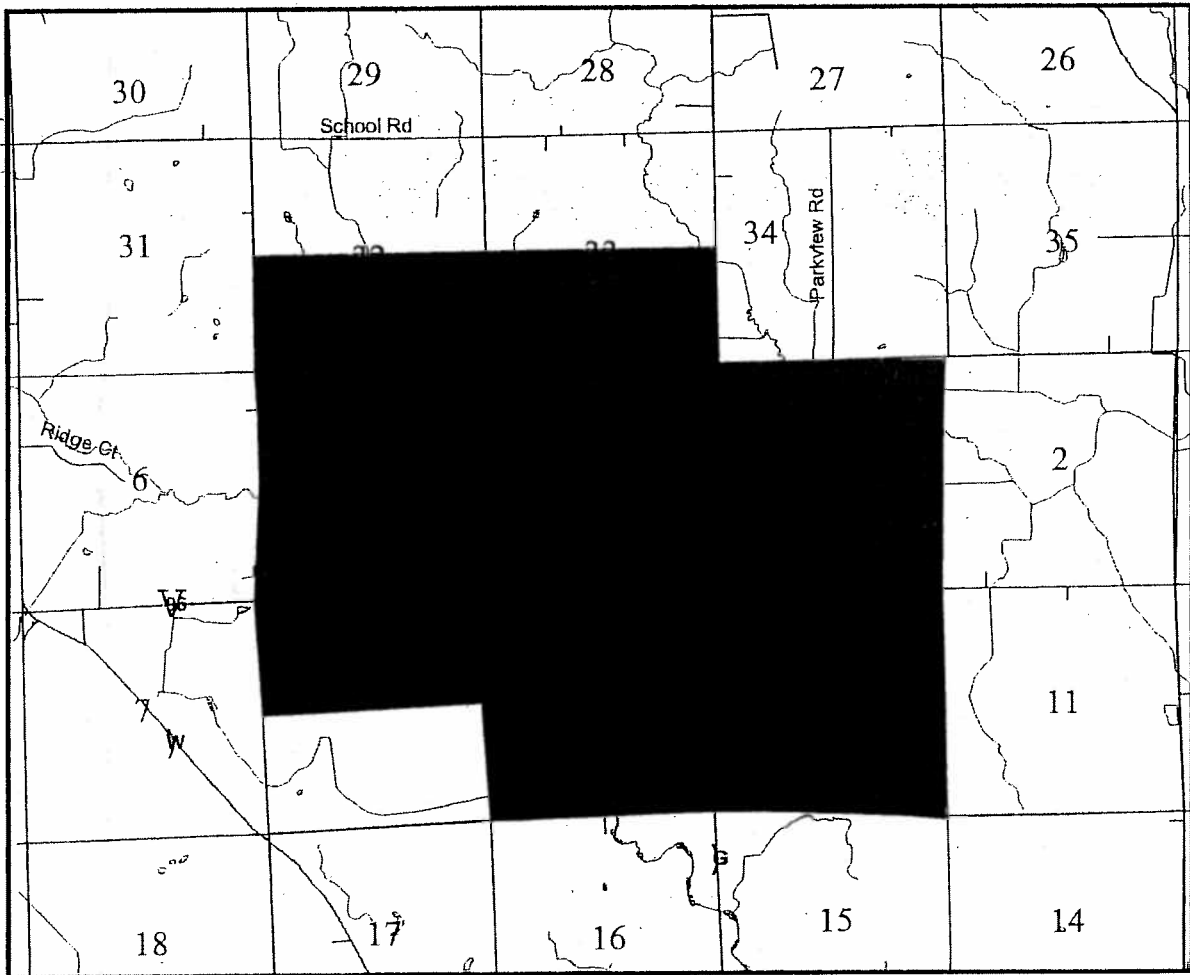

# Adams County, Towns of Dell Prairie, Jackson New Haven & Springville

T 14-15N R6-7 E PA 05-01-01\*

All uses of atrazine are prohibited on lands within the shaded regions.  
There are five prohibition areas in Adams County. Refer to each map  
for specific locations

\* Note: This PA is an expansion of PA02-01-01, PA 00- 01-01, PA 98-01-01.  
PA 95-01-01 & PA 94-01-01.

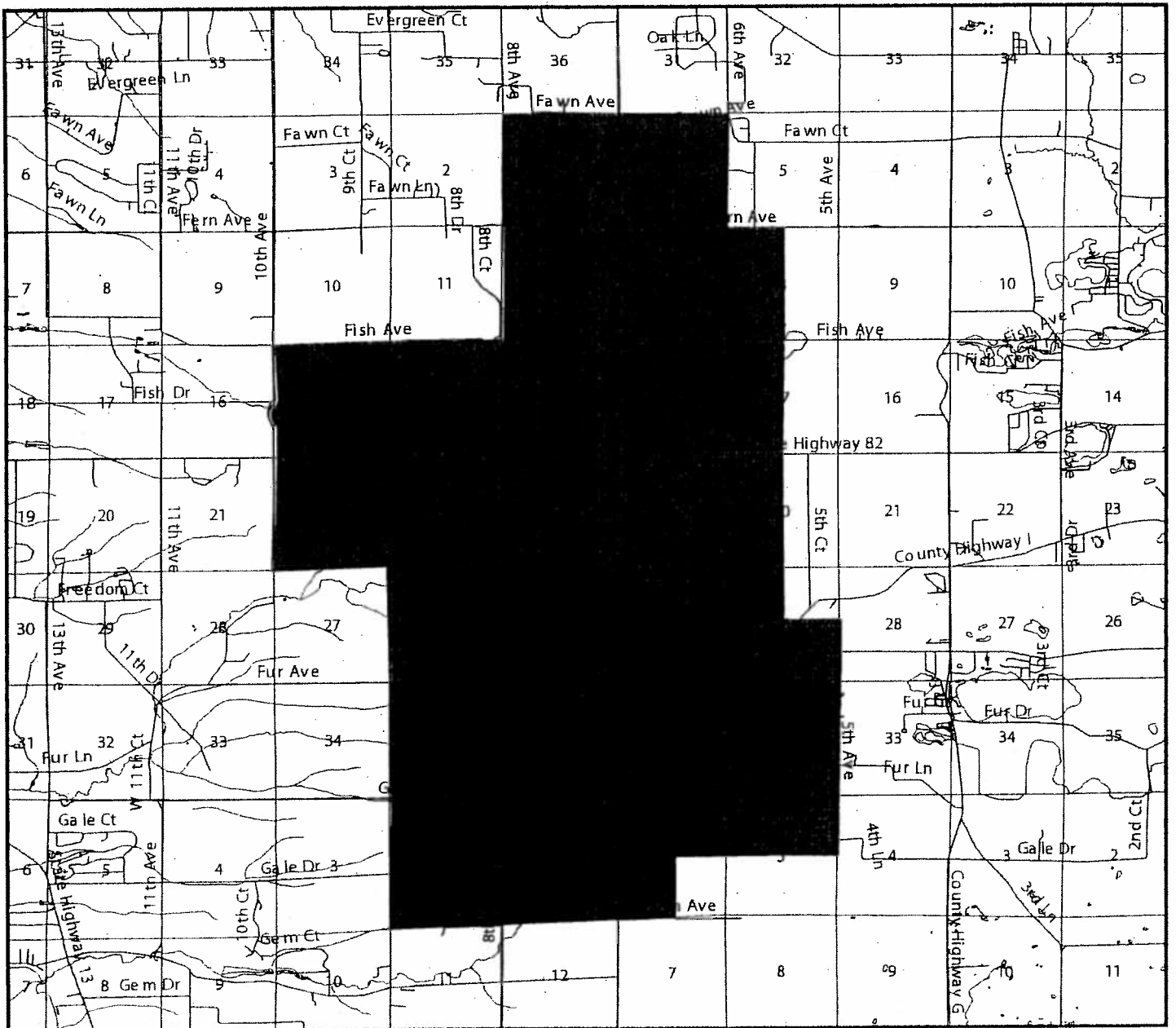
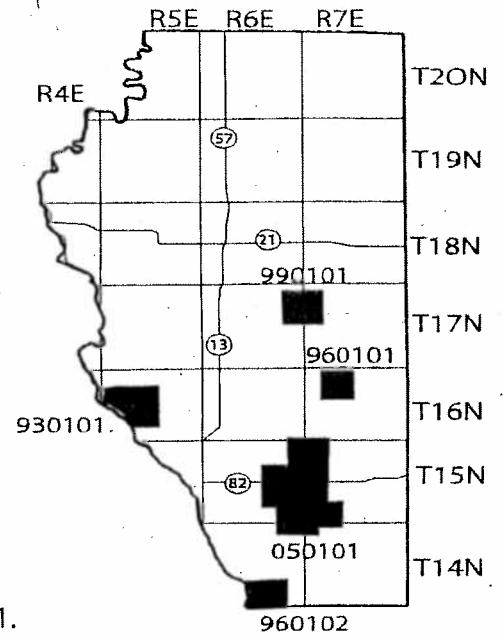

# Columbia County

Town of Caledonia

T11-12N R8-9E

PA 94-11-01\*

All uses of atrazine are prohibited on lands within the shaded regions. There are seven prohibition areas in Columbia County. Refer to each map for specific locations.

\*Note: This PA is an expansion of PA93-11-02

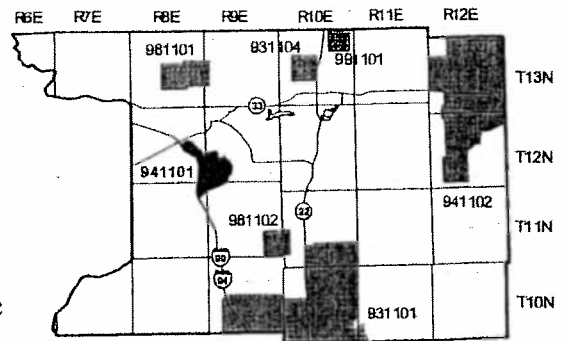

# Columbia County

## Towns of Courtland and Randolph

### T12-13N R12E PA 94-11-02\*

All uses of atrazine are prohibited on lands within the shaded regions. There are seven prohibition areas in Columbia County. Refer to each map for specific locations.

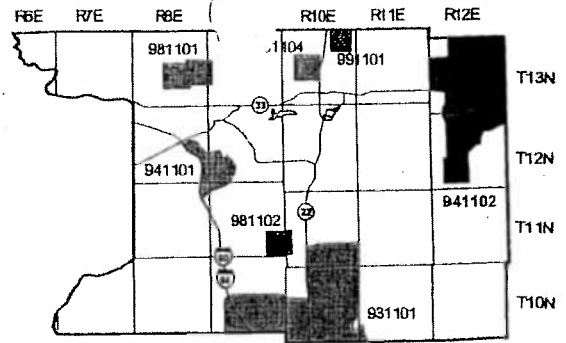

\*Note: This PA is an expansion of PA 93-11-03.

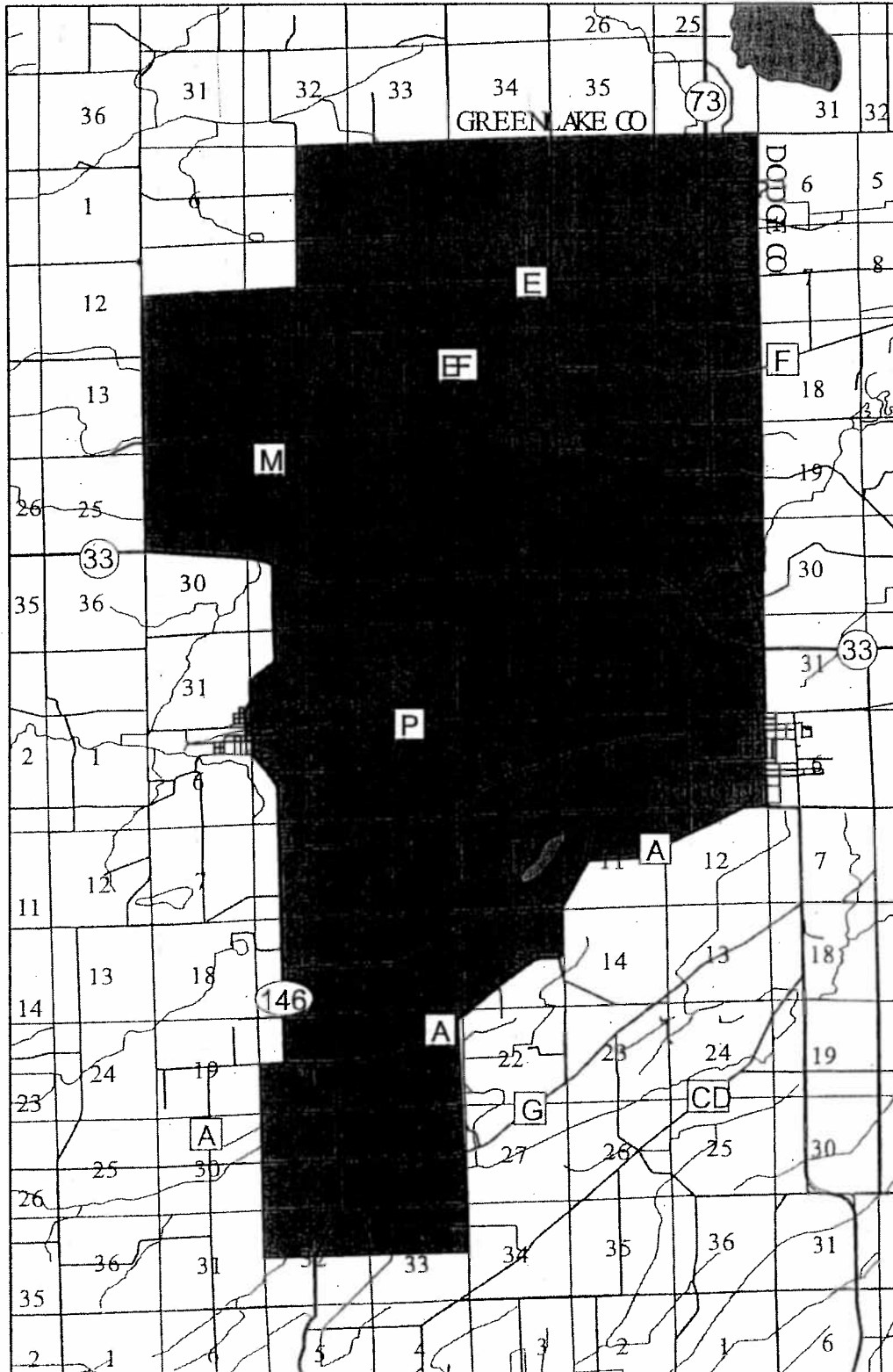

# Juneau County

## Town of Lindina

### T15N R3E PA 94-29-01\*

All uses of atrazine are prohibited on lands within the shaded regions. There are two prohibition areas in Juneau County. Refer to each map for specific locations.

\*Note: This PA is an expansion of PA 93-29-01.

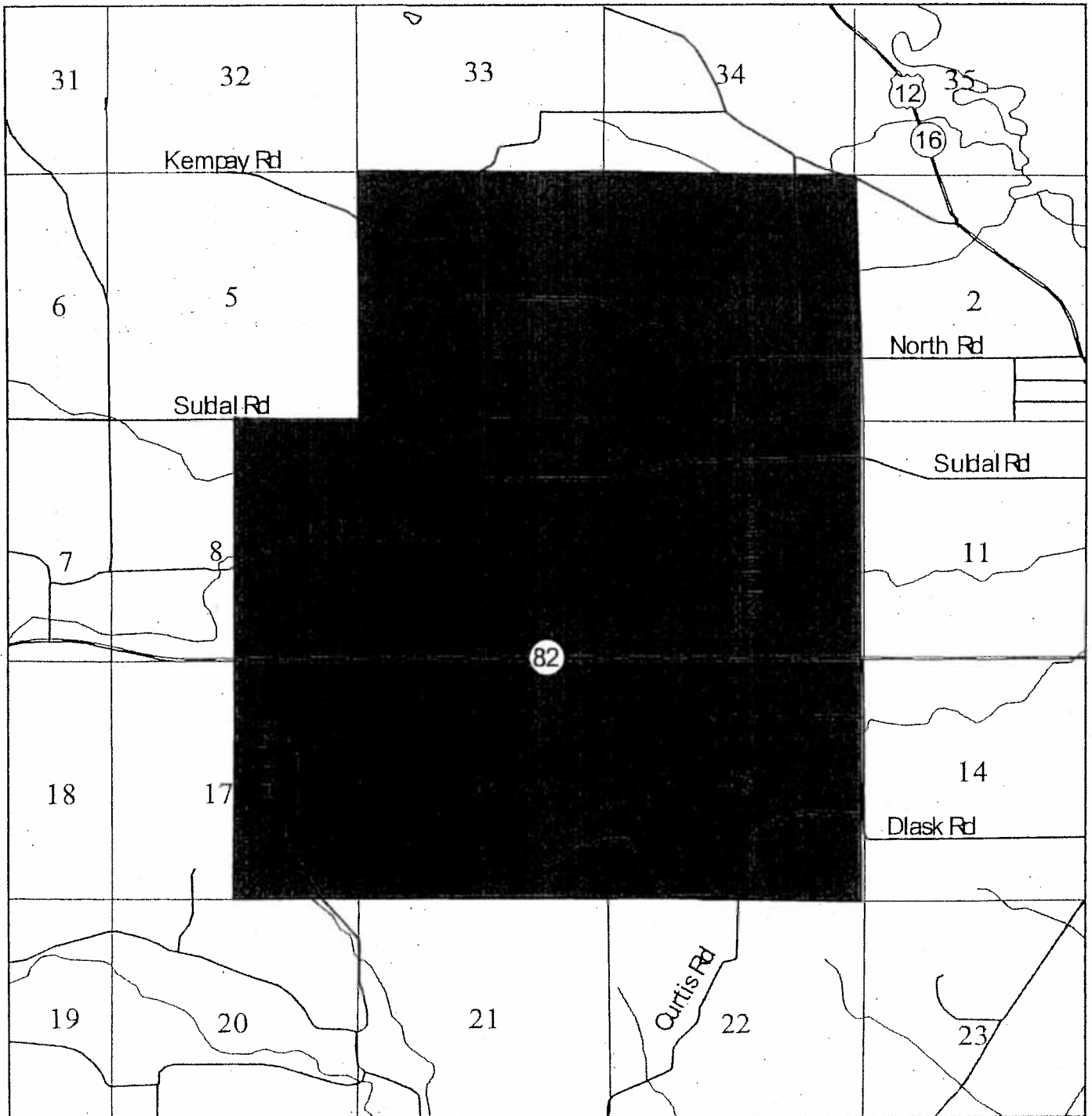
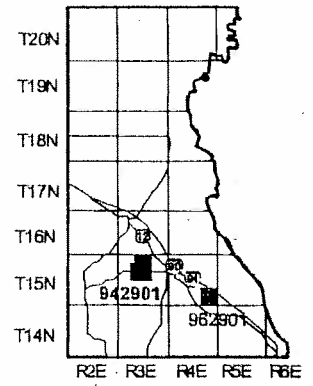

# Marathon County

## Towns of Cassel & Emmet

### T27-28NR5E PA 98-37-01\*

All uses of atrazine are prohibited on lands within the shaded regions. There are two prohibition areas in Marathon County and a third shared with Portage County.

\*Note: This PA is an expansion of PA 93-37-01.

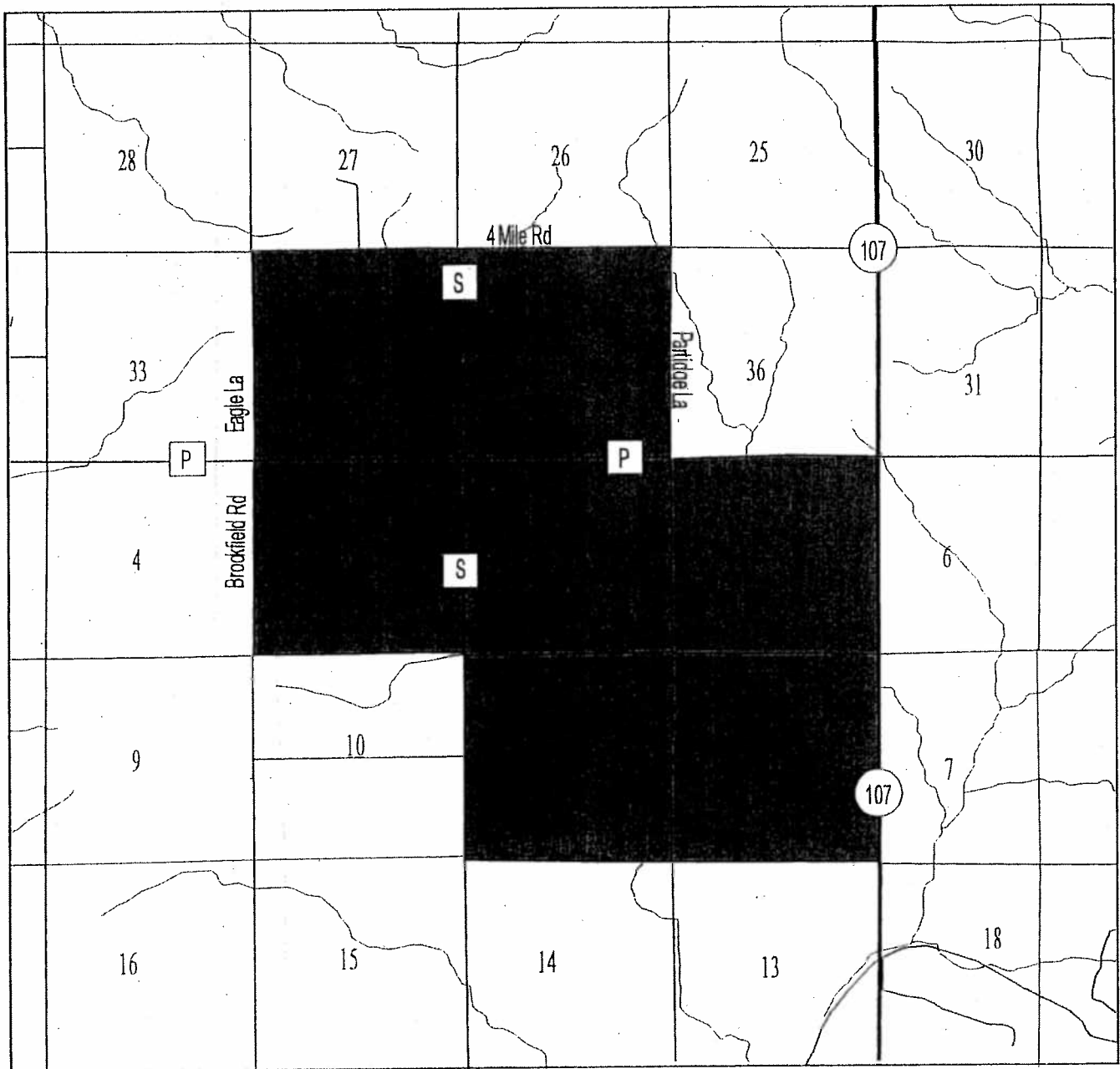
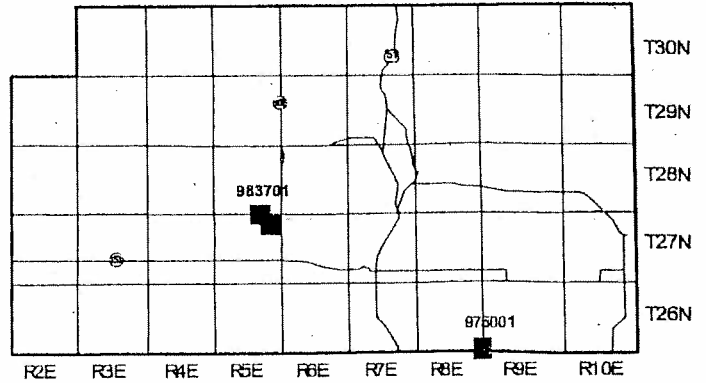



# Marquette County

## Town of Newton

### T17N R9E PA 96-39-01\*

All uses of atrazine are prohibited on lands within the shaded regions. There are two prohibition areas in Marquette County. Refer to each map for specific locations.

Note: This PA is an expansion of PA 95-39-01.

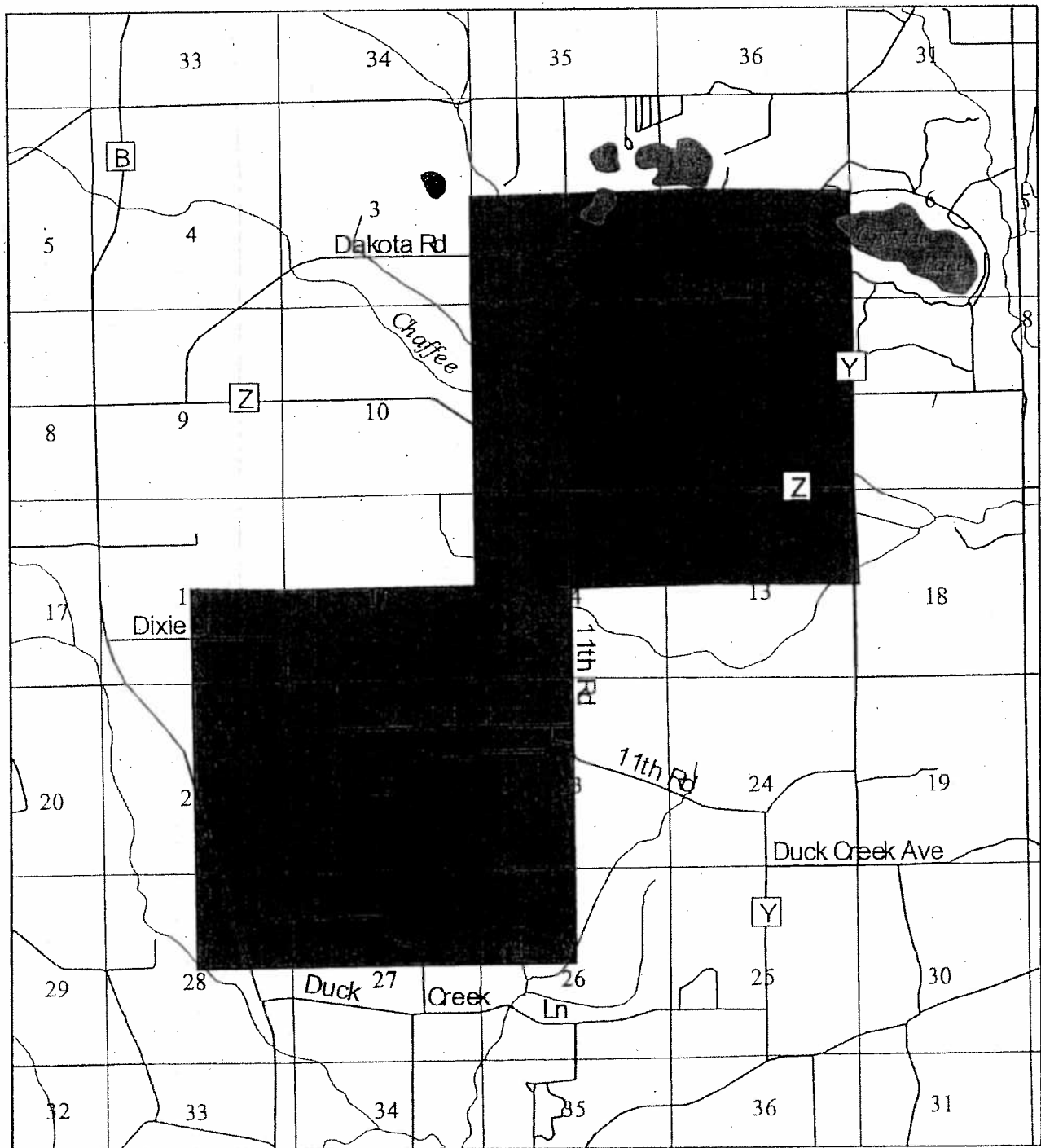
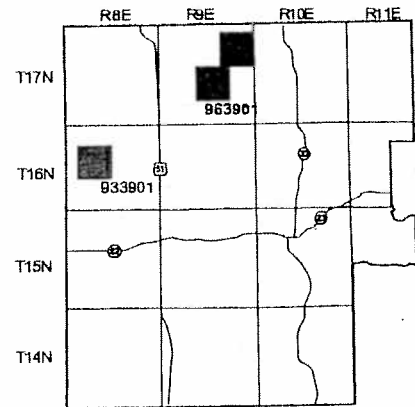

# Portage County Towns of Amherst & New Hope T23-24N R10E PA 99-50-01\*

All uses of atrazine are prohibited on lands within the shaded regions. There are eight prohibition areas in Portage County. Refer to each map for specific locations.  
 \*Note: This PA is an expansion of PA 95-50-01 & PA 94-50-03.

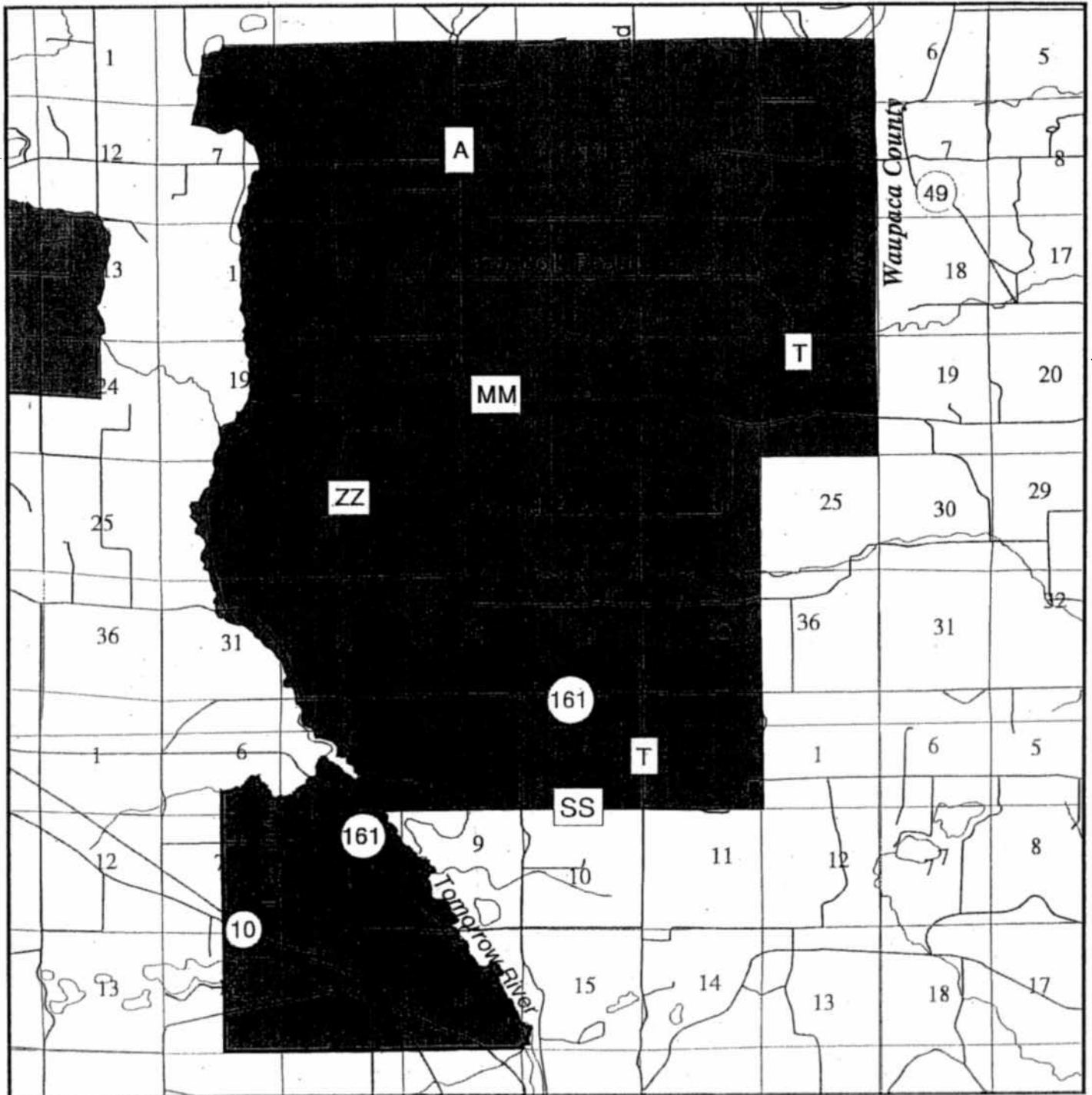
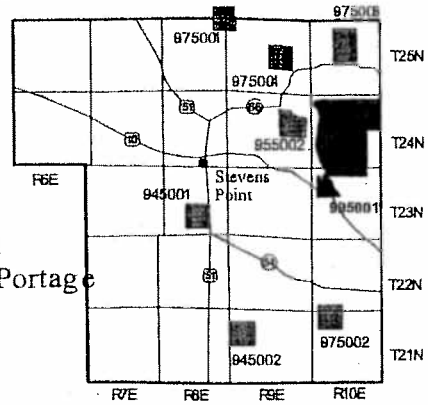

# Rock County Towns of Plymouth, & Spring Valley T2N R10-11E PA 97-54-01

All uses of atrazine are prohibited on lands within the shaded regions. There are seven prohibition areas in Rock County. Refer to each map for specific locations.

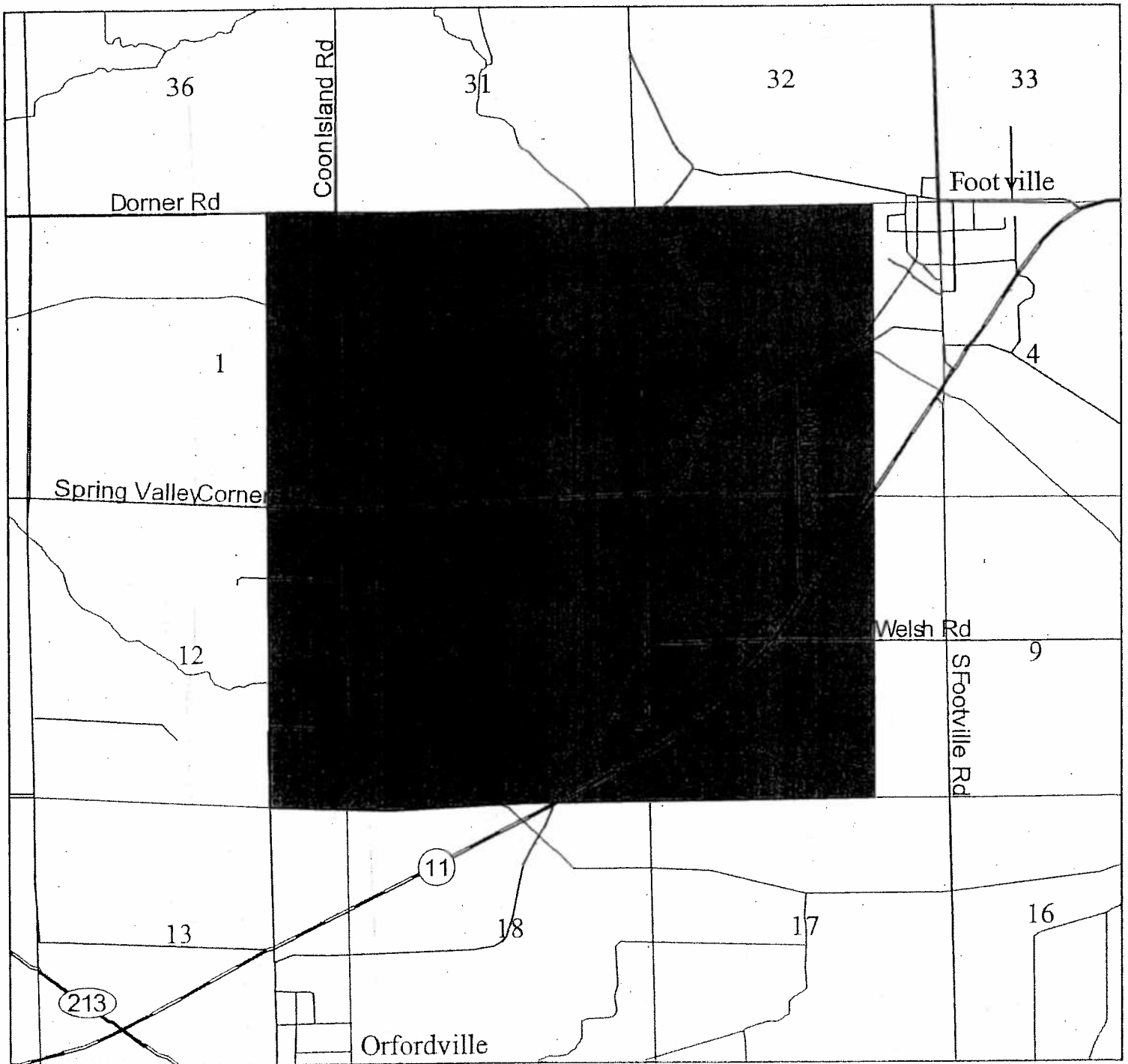
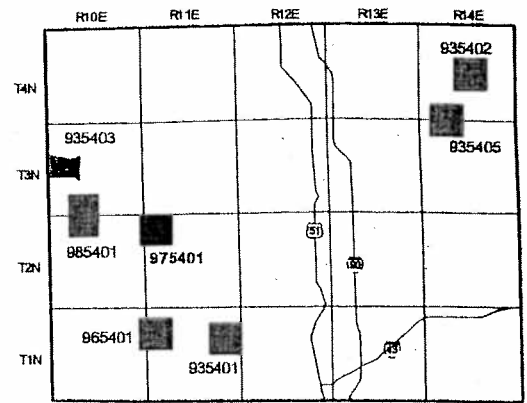

Attachments for ATCP 30 (Created)

# SAUK COUNTY

## Lower Wisconsin River Valley

### Atrazine Prohibition Area

#### PA 93-57-04

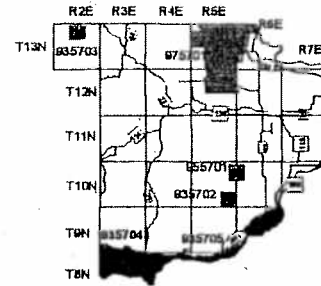

"Lower Wisconsin River Valley" means the river terraces and flood plain on either side of the Wisconsin River, downstream of the highway 60 bridge at Prairie du Sac and upstream of the confluence of the Wisconsin and Mississippi Rivers, except that atrazine may be applied to medium- and fine-textured soils in Township 9 North Range 1 West, sections 27, 28, 29, 30, 31, 32, 33, and 34 and Township 9 North, Range 2 West, sections 25, 26, 27, 28, 32, 33, 34, 35, and 36 in compliance with ss. ATCP 30.30 through ATCP 30.32.

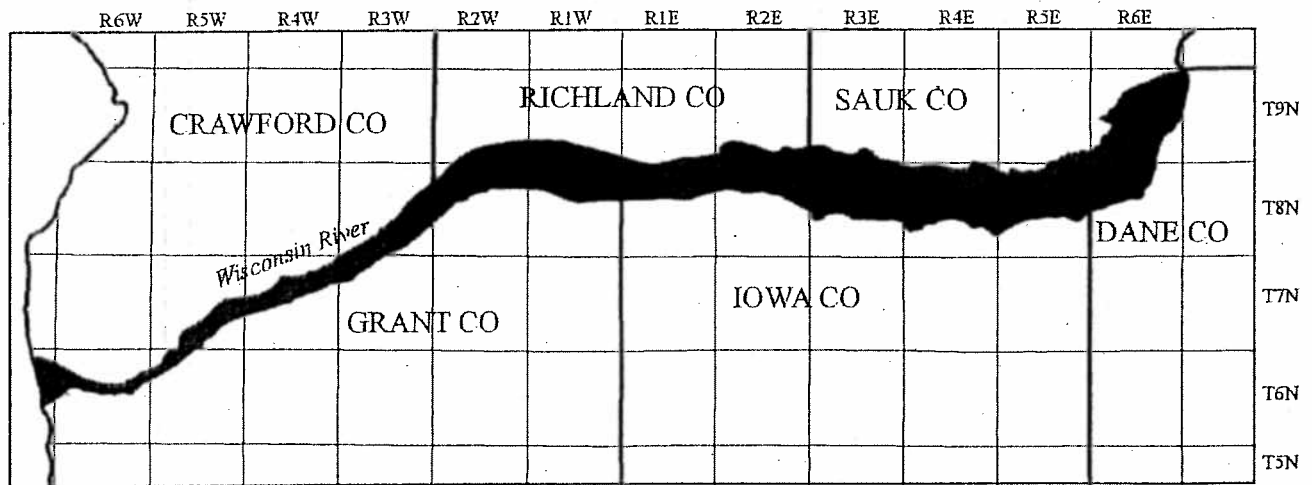

# Waupaca County

## Town of Dayton

### 21N R1E PA 98-6901

All uses of atrazine are prohibited on lands within the shaded regions. There are four prohibition areas in Waupaca County, one of which is shared with Outagamie County. Refer to each map for specific locations.

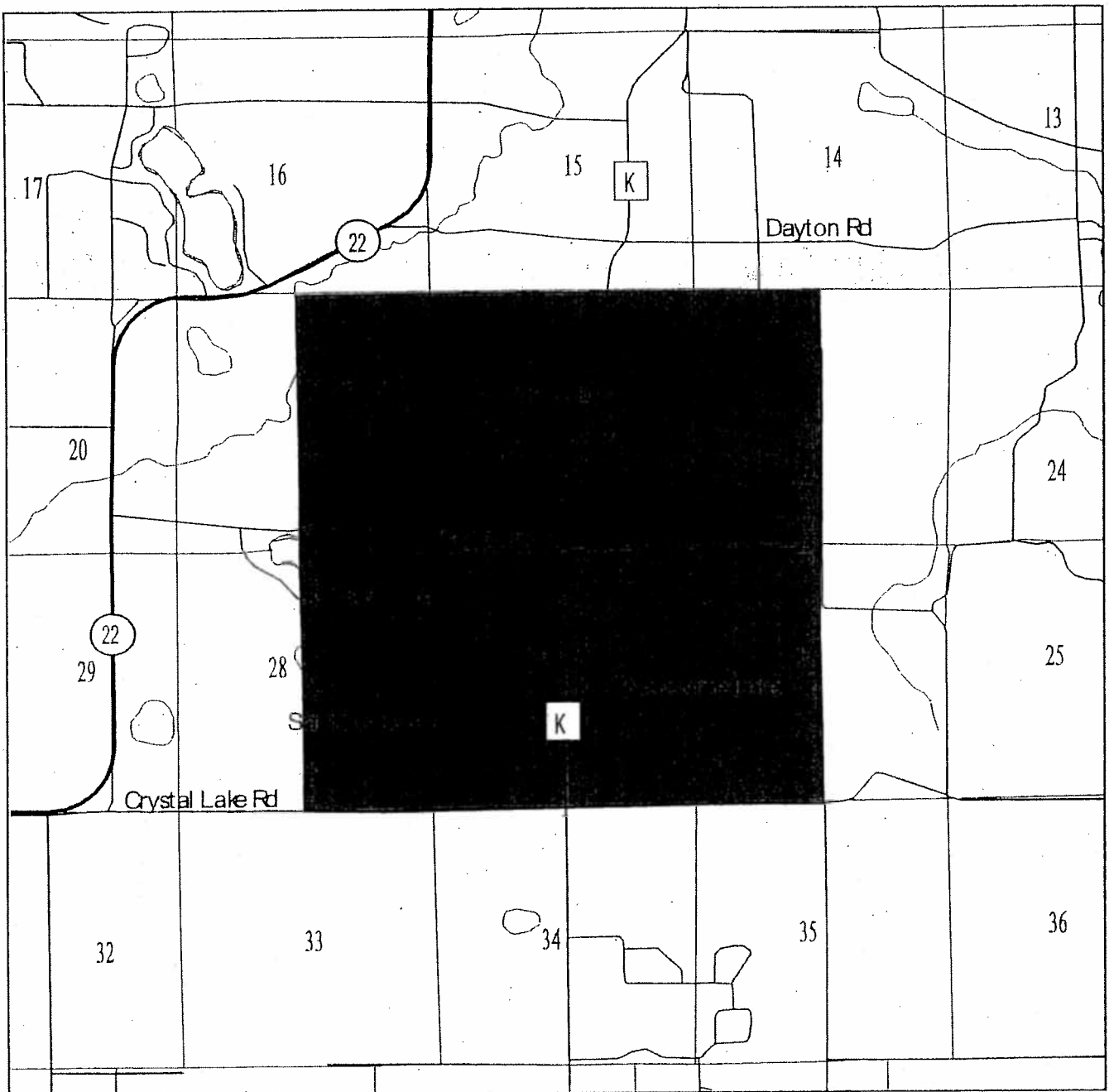
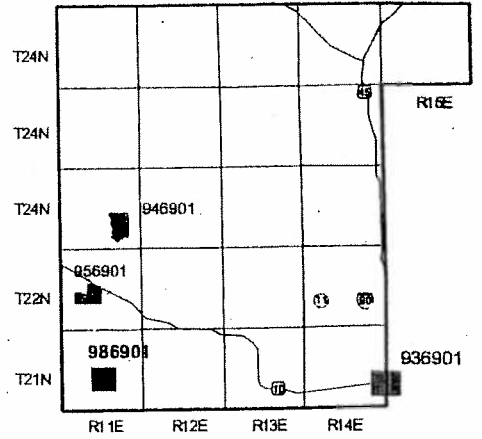

# Waushara County

## Towns of Rose, Spring Water Mount Morris & Wautoma

### T19-20N R10-11EPA 04-70-01\*

All uses of atrazine are prohibited on lands within the shaded regions. There are five prohibition areas in Waushara County. Refer to each map for specific locations.

\*Note: This PA is an expansion of PA93-70-03.

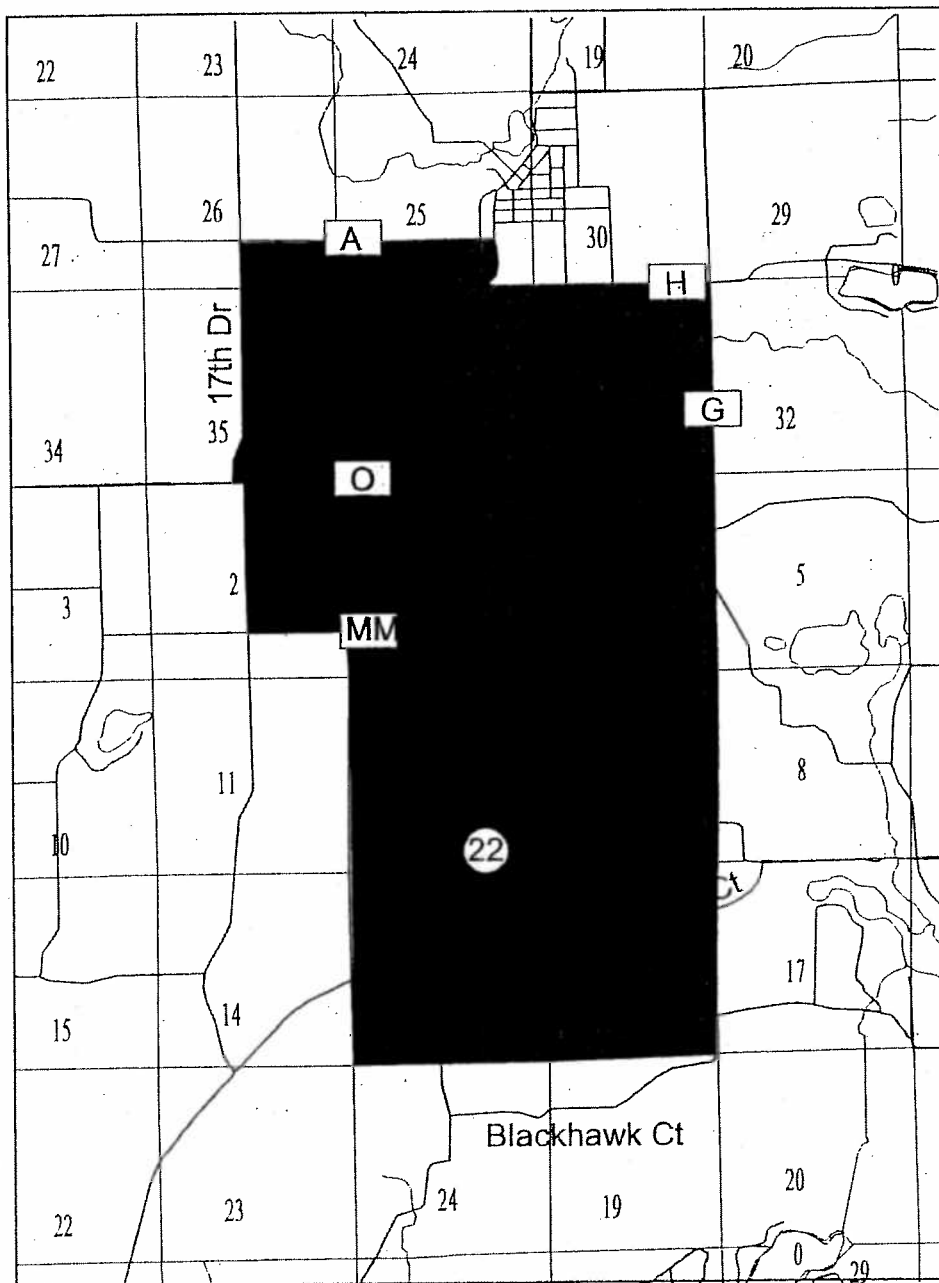
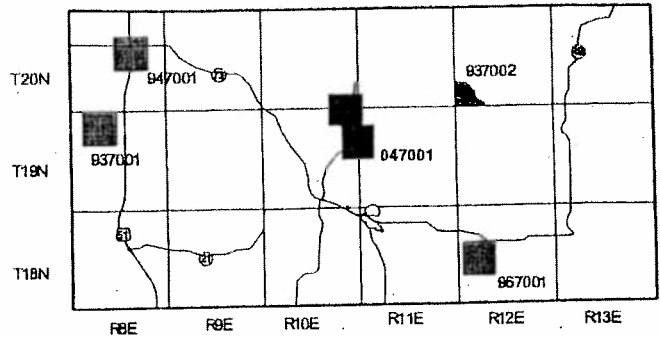

**CRAWFORD COUNTY**  
**Lower Wisconsin River Valley**  
**Atrazine Prohibition Area**  
**PA 93-57-04**

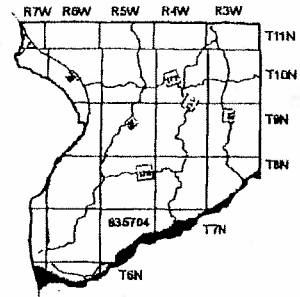

"Lower Wisconsin River Valley" means the river terraces and flood plain on either side of the Wisconsin River, downstream of the highway 60 bridge at Prairie du Sac and upstream of the confluence of the Wisconsin and Mississippi Rivers, except that atrazine may be applied to medium- and fine-textured soils in Township 9 North, Range 1 West, sections 27, 28, 29, 30, 31, 32, 33, and 34 and Township 9 North, Range 2 West, sections 25, 26, 27, 28, 32, 33, 34, 35, and 36 in compliance with ss. ATCP 30.30 through ATCP 30.32.

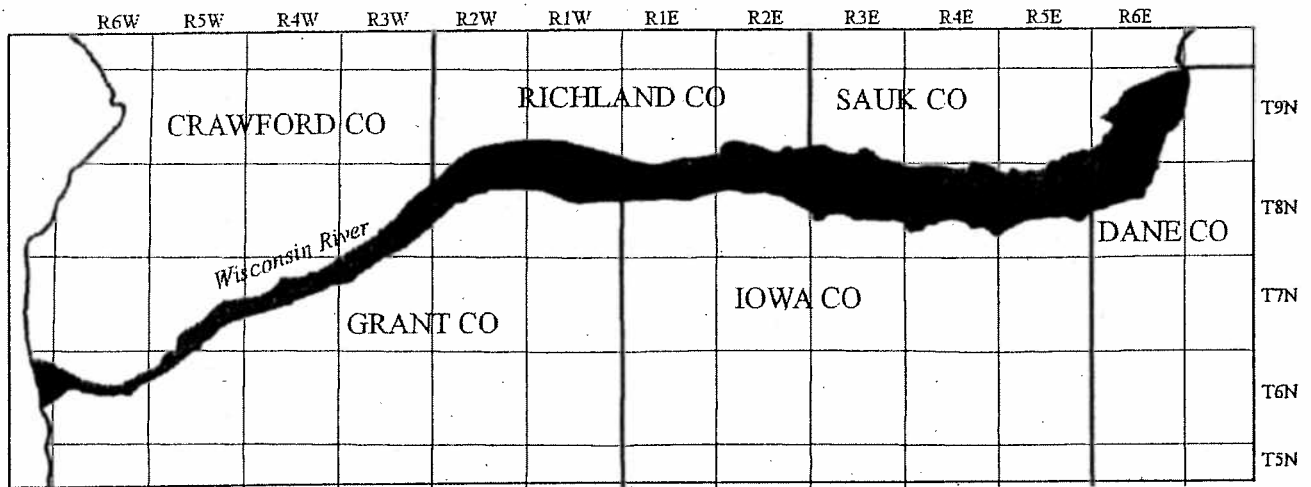



**DANE COUNTY**  
**Lower Wisconsin River Valley**  
**Atrazine Prohibition Area**  
**PA 93-57-04**

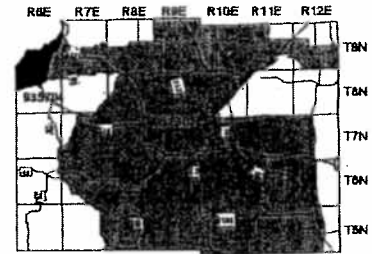

"Lower Wisconsin River Valley" means the river terraces and flood plain on either side of the Wisconsin River, downstream of the highway 60 bridge at Prairie du Sac and upstream of the confluence of the Wisconsin and Mississippi Rivers, except that atrazine may be applied to medium- and fine-textured soils in Township 9 North Range 1 West, sections 27, 28, 29, 30, 31, 32, 33, and 34 and Township 9 North, Range 2 West, sections 25, 26, 27, 28, 32, 33, 34, 35, and 36 in compliance with ss. ATCP 30.30 through ATCP 30.32.

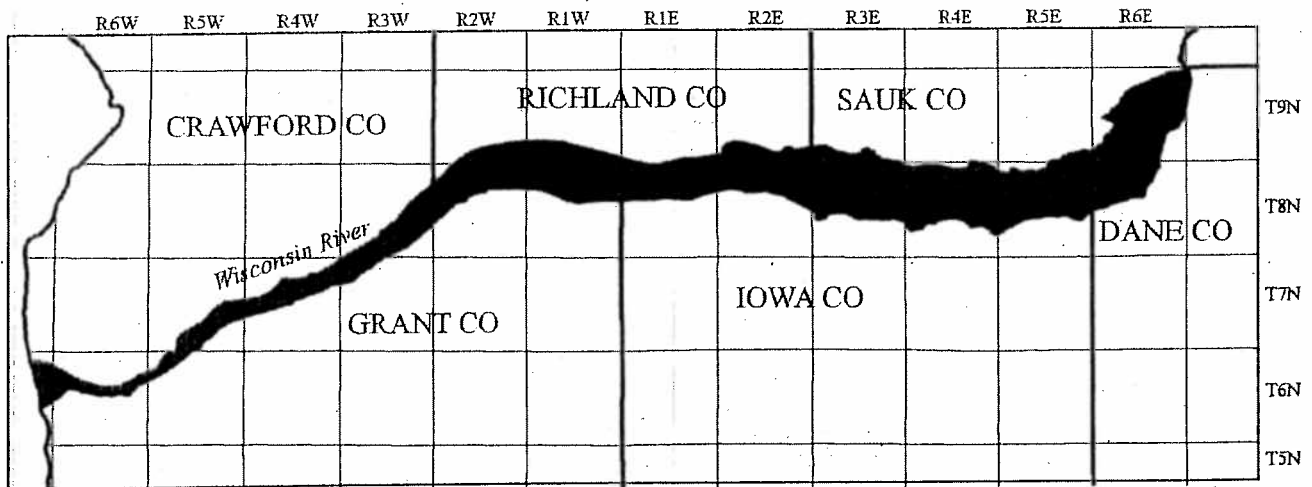

**GRANT COUNTY**  
**Lower Wisconsin River Valley**  
**Atrazine Prohibition Area**  
**PA 93-57-04**

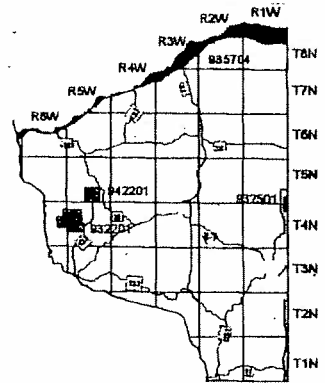

"Lower Wisconsin River Valley" means the river terraces and flood plain on either side of the Wisconsin River, downstream of the highway 60 bridge at Prairie du Sac and upstream of the confluence of the Wisconsin and Mississippi Rivers, except that atrazine may be applied to medium- and fine-textured soils in Township 9 North Range 1 West, sections 27, 28, 29, 30, 31, 32, 33, and 34 and Township 9 North, Range 2 West, sections 25, 26, 27, 28, 32, 33, 34, 35, and 36 in compliance with ss. ATCP 30.30 through ATCP 30.32.

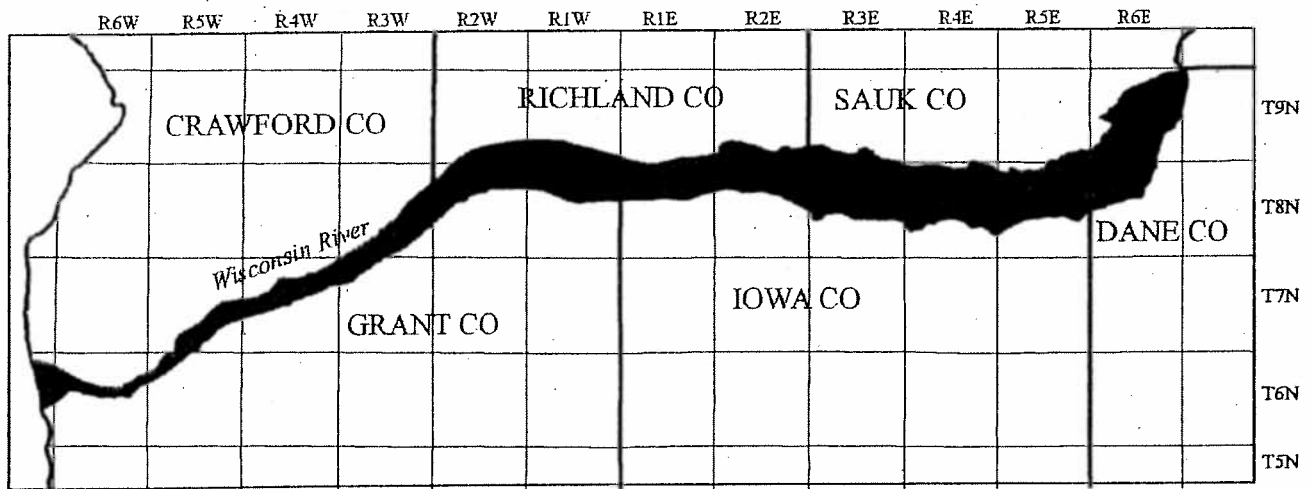

**IOWA COUNTY**  
**Lower Wisconsin River Valley**  
**Atrazine Prohibition Area**  
**PA 93-57-04**

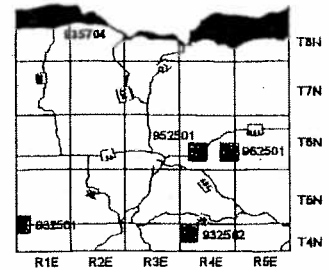

"Lower Wisconsin River Valley" means the river terraces and flood plain on either side of the Wisconsin River, downstream of the highway 60 bridge at Prairie du Sac and upstream of the confluence of the Wisconsin and Mississippi Rivers, except that atrazine may be applied to medium- and fine-textured soils in Township 9 North Range 1 West, sections 27, 28, 29, 30, 31, 32, 33, and 34 and Township 9 North, Range 2 West, sections 25, 26, 27, 28, 32, 33, 34, 35, and 36 in compliance with ss. ATCP 30.30 through ATCP 30.32.

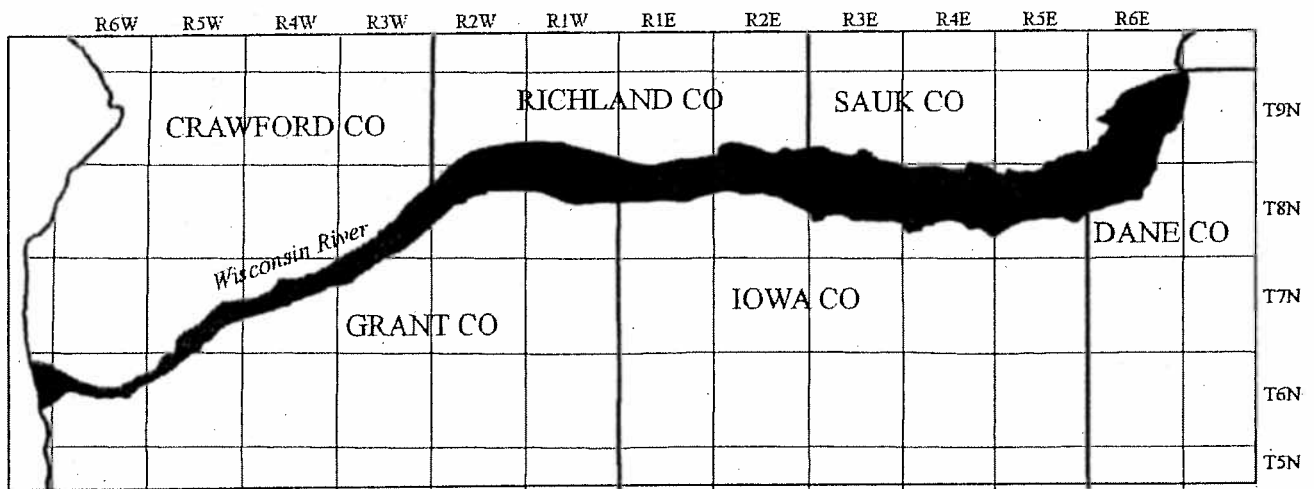

**RICHLAND COUNTY**  
**Lower Wisconsin River Valley**  
**Atrazine Prohibition Area**  
**PA 93-57-04**

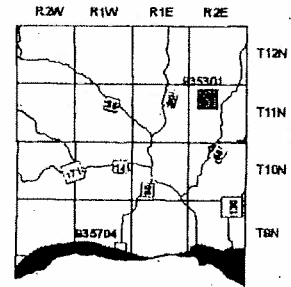

"Lower Wisconsin River Valley" means the river terraces and flood plain on either side of the Wisconsin River, downstream of the highway 60 bridge at Prairie du Sac and upstream of the confluence of the Wisconsin and Mississippi Rivers, except that atrazine may be applied to medium- and fine-textured soils in Township 9 North Range 1 West, sections 27, 28, 29, 30, 31, 32, 33, and 34 and Township 9 North, Range 2 West, sections 25, 26, 27, 28, 32, 33, 34, 35, and 36 in compliance with ss. ATCP 30.30 through ATCP 30.32.

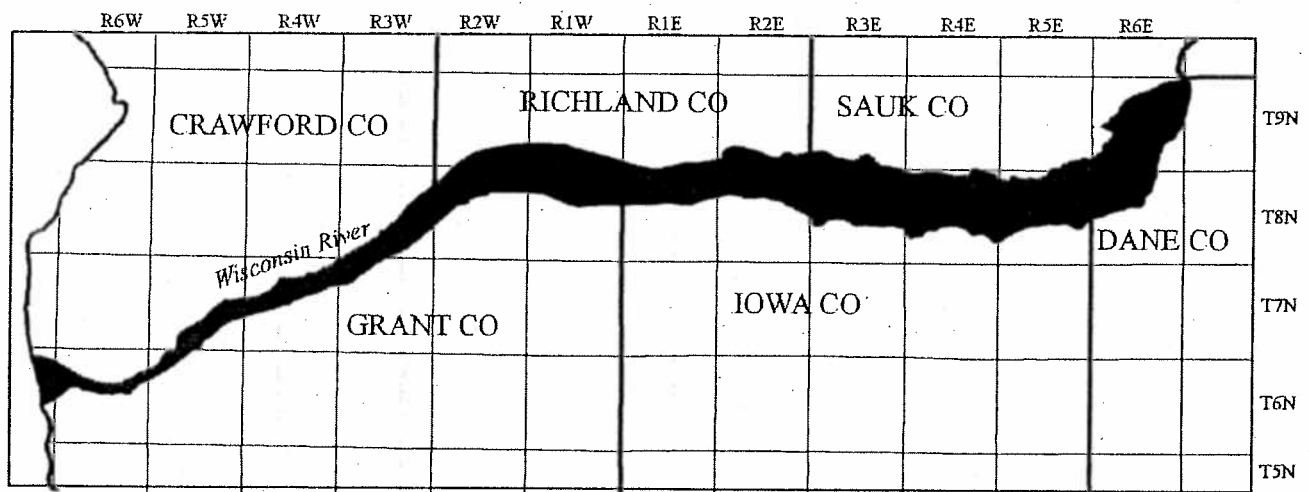

Wisconsin Department of Agriculture, Trade and Consumer Protection

**Business Impact Analysis**

**Rule Subject:** Minor and Technical Rule Changes  
**Adm. Code Reference:** ATCP 3, 10, 12, 21, 29, 30, 31, 33, 40, 50, 51, 55, 60, 70, 75, 90, 92, 103, 118, 123, 124, , 136 and 160.  
**Rules Clearinghouse #:** 08-075  
**DATCP Docket #:** 06-R-13

**Rule Summary**

This rule makes minor or technical changes to a number of current DATCP rules. This rule does all of the following:

**Electronic Processing of License Applications; Cost Recovery**

- Authorizes DATCP to assess a \$3 fee for electronic licensing transactions (in addition to other license fees), to cover DATCP's electronic licensing costs. Electronic processing, if offered, is offered as a voluntary option for license applicants.

**Agricultural Chemical Cleanup Program; Surcharge Adjustment**

- Reduces current agricultural chemical cleanup program surcharges paid by pesticide and fertilizer license holders, consistent with 2007 Wisconsin Act 20 (biennial budget act). DATCP has already implemented the reduced statutory surcharges (this rule merely conforms current rules to the new statutory amounts).

**Atrazine Use Regulations**

- Revises the format of current maps showing some of the land areas where application of atrazine pesticides is currently prohibited by rule (this rule does not change the actual prohibition areas).
- Restores a provision inadvertently deleted from the atrazine rule in a prior rulemaking proceeding, when the rule was modified for other reasons. The restored provision allows farmers to apply an additional 0.5 lbs. of atrazine per acre on medium- or fine-textured soils (up to 1.5 lbs. per acre rather than 1.0 lb. per acre), if no atrazine was applied in the preceding year. The restored provision is consistent with how DATCP has always administered the atrazine rule, so there will be no change in actual use practices.

### **Pesticide Manufacturers and Labelers Fees**

- Clarifies that a current rule prohibiting refunds of pesticide license fees does not prohibit certain reimbursements that are authorized by statute and paid as credits against the next year's license fees.

### **Land and Water Conservation Program**

- Updates technical standards incorporated by reference in current land and water conservation rules (ATCP 50). This rule does not substantially alter current standards or requirements.
- Gives DATCP more latitude to extend land and water conservation funding for county cost-share contracts with landowners that were signed, but not completed, during the preceding year (extends signing deadline from December 1 to December 31).
- Extends the current mid-year deadline for counties to file cost-share reimbursement requests with DATCP (from June 1 to July 1).
- Updates current standards for the certification of agricultural engineering practitioners under the land and water conservation program, consistent with current standards published by the United States Department of Agriculture, Natural Resource Conservation Service ("NRCS").
- Updates current standards used by certified soil testing laboratories under the land and water conservation program, consistent with updated standards published by the University of Wisconsin-Extension and University of Wisconsin-Madison.

### **Meat Inspection**

- Corrects erroneous cross-references to federal meat inspection regulations in state meat inspection rules.

### **Dairy Inspection**

- Changes, from 7 days to 14 days, the time period within which dairy plants must report high somatic cell counts in goat milk and take follow-up samples related to high bacterial counts.

### **Weights and Measures**

- Updates technical standards incorporated by reference in current packaging and labeling and weights and measures rules (ATCP 90 & 92), including the latest standards published by the National Institute of Standards and Technology.

### **Car Rental Notices**

- Incorporates statutory provisions requiring car rental companies to notify prospective renters if the rental company may charge the renter's credit card for forfeitures and other costs incurred but not paid by the renter for nonmoving traffic violations (parking tickets).

### **Fair Premium Aids**

- Authorizes DATCP to pay county and district fair premium aids based on total county and district fair premiums paid (current rule requires payment based on total premiums less entry fees).

### **Other Technical Changes**

- Modifies current *notes* to reflect the fact that rules and related documents are now filed with the legislative reference bureau, not the revisor of statutes or secretary of state (the revisor of statutes office was eliminated by 2007 Wis. Act 20).
- Corrects minor errors in current rules.
- Makes minor organizational, drafting and terminology changes.

### ***Business Impact***

This rule will not have any significant impact on small business or other business. This rule makes minor and technical "housekeeping" changes that will not have a significant impact on business standards, costs or operations.

### ***Steps to Assist Small Business***

This rule does not have a significant impact on small business, and does not make any special exceptions for small business.

*Conclusion*

This rule does not materially affect small business, and is not subject to the delayed small business effective date provided in s. 227.22(2)(e), Stats.

Dated this 29<sup>th</sup> day of October, 2008

STATE OF WISCONSIN  
DEPARTMENT OF AGRICULTURE,  
TRADE AND CONSUMER PROTECTION

By 

James K. Matson,  
Chief Legal Counsel



**FISCAL ESTIMATE**

DOA-2048-N(R10/98)

ORIGIN  UPDATED

CORRECTED  SUPPLEMENTAL

LRB No. Bill/Adm. Rule No. Ch. ATCP 3, 10, 12, 21, 29, 30, 31, 33, 40, 42, 50, 51, 55, 67, 68, 70, 75, 80, 82, 103, 118, 123, 124, 138 and 160.  
Amendment No. If Applicable

**Subject**  
Minor and Technical Rule Changes

**Fiscal Effect**  
State:  No State Fiscal Effect  
Check columns below only if bill makes a direct appropriation or affects a sum certain appropriation  
 Increase Existing Appropriation  Increase Existing Revenues  
 Decrease Existing Appropriation  Decrease Existing Revenues  
 Create New Appropriation  
 Increase Costs - May be possible to Absorb Within Agency's Budget  Yes  No  
 Decrease Costs

**Local:**  No Local Government Costs  
1.  Increase Costs  Permissive  Mandatory  
2.  Decrease Costs  Permissive  Mandatory  
3.  Increase Revenues  Permissive  Mandatory  
4.  Decrease Revenues  Permissive  Mandatory  
5. Types of Local Governmental Units Affected:  
 Towns  Villages  Cities  
 Counties  Others  
 School Districts  WTCS Districts

**Fund Sources Affected**  GPR  FED  PRO  PRS  SEG  SEG-S **Affected Ch. 20 Appropriations**

**Assumptions Used in Arriving at Fiscal Estimate**

This rule makes minor technical changes to a number of existing rules. This rule will have no fiscal effect on the department or local units of government.

-This rule will allow the department to charge license applicants an additional \$3 for electronic processing of licenses (as authorized by statute), if applicants choose that option. However, that option is not currently available except on a few simple licenses.

-This rule adjusts current agricultural chemical cleanup program surcharges paid by fertilizer and pesticide license holders to conform to the new (lower) amounts specified by statute. However, DATCP has already implemented the new amounts, so this rule will not change the surcharge amounts currently being paid.

-This rule will not have a substantial impact on DATCP administrative or operating costs.

**Long-Range Fiscal Implications**

Agency/Prepared by: (Name & Phone No.)  
Dept of Agriculture, Trade & Consumer Protection (608) 224-5022  
DATCP/James Matson

Authorized Signature/Telephone No. (608) 224-4800  
*Karen Van Johnson*  
William Walker (608) 224-4353

Date  
10/29/2008