

# 07hr\_SC-ENR\_sb0119\_pt05



(FORM UPDATED: 08/11/2010)

## WISCONSIN STATE LEGISLATURE ... PUBLIC HEARING - COMMITTEE RECORDS

### 2007-08

(session year)

### Senate

(Assembly, Senate or Joint)

### Committee on ... Environment and Natural Resources (SC-ENR)

#### COMMITTEE NOTICES ...

- Committee Reports... **CR**
- Executive Sessions... **ES**
- Public Hearings ... **PH**

#### INFORMATION COLLECTED BY COMMITTEE FOR AND AGAINST PROPOSAL

- Appointments ... **Appt** (w/Record of Comm. Proceedings)
- Clearinghouse.Rules ... **CRule** (w/Record of Comm. Proceedings)
- Hearing Records ... **HR ... bills and resolutions** (w/Record of Comm. Proceedings)
  - (**ab** = Assembly Bill)                      (**ar** = Assembly Resolution)                      (**ajr** = Assembly Joint Resolution)
  - (**sb** = Senate Bill)                              (**sr** = Senate Resolution)                      (**sjr** = Senate Joint Resolution)
- Miscellaneous ... **Misc**

\* Contents organized for archiving by: Mike Barman (LRB) (August 2012)

June-2014

# Great Ships Initiative

## Senate Committee on Environment and Natural Resources

Madison, Wisconsin  
May 23, 2007

**STEVE FISHER**  
EXECUTIVE DIRECTOR  
AMERICAN GREAT LAKES PORTS ASSOCIATION  
WASHINGTON, DC

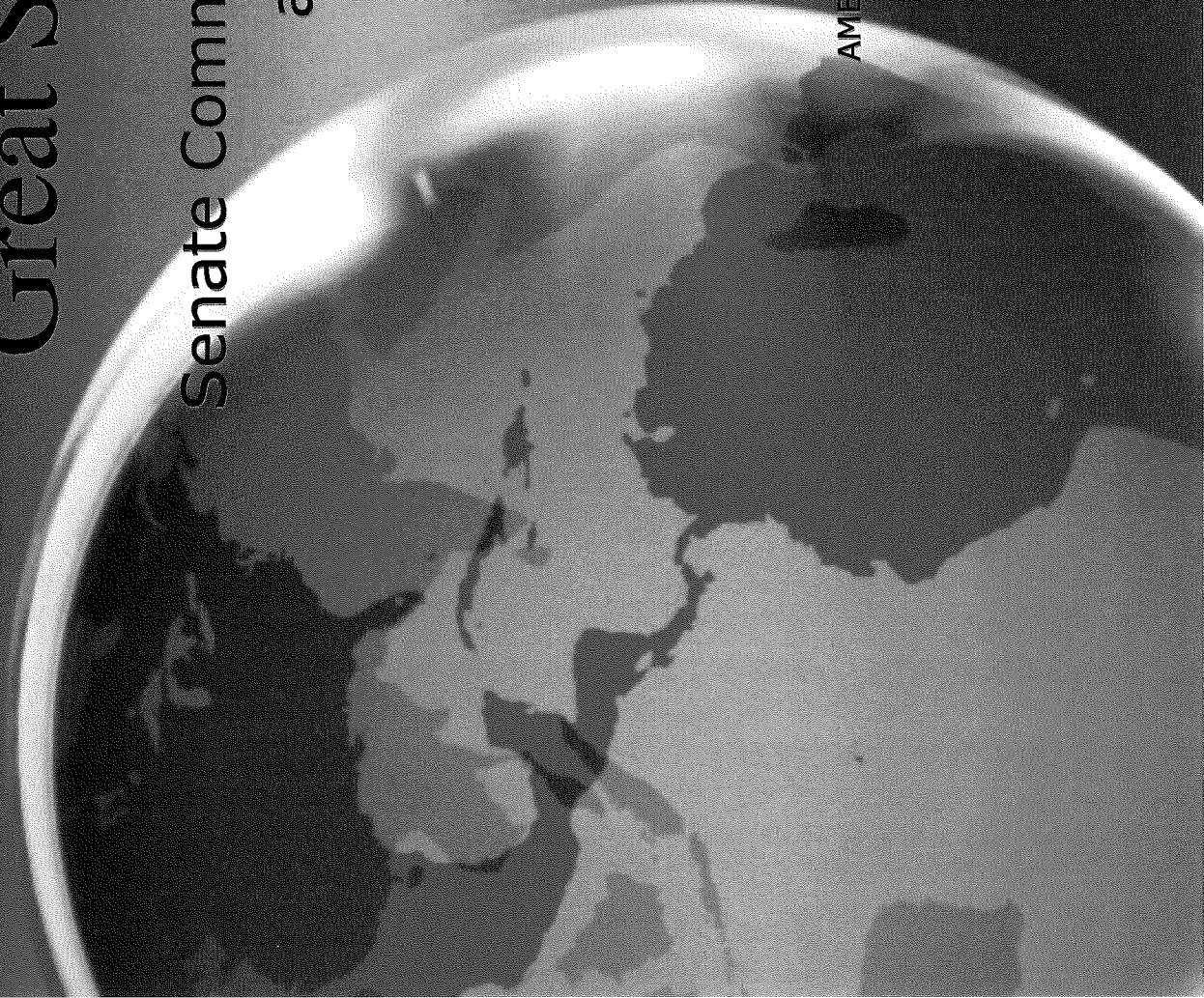



# Project Genesis

"Great Lakes Biological Pollution Prevention Project"  
funded by the  
Great Lakes Protection Fund

- outreach effort to maritime industry
- proposed an industry led effort
- GSI designed as the response



# Objective

To end ship mediated  
introductions of aquatic invasive  
species into the Great Lakes



Located in Superior, WI

# Project Elements

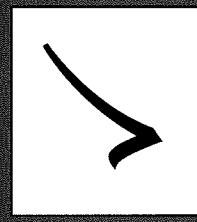

technology incubation / testing



harbor monitoring



installation assistance / financing



post installation monitoring / assistance

# Project Managers

**NORTHEAST-MIDWEST INSTITUTE**

**AMERICAN GREAT LAKES PORTS  
ASSOCIATION**

**NATIONAL FISH AND WILDLIFE FOUNDATION**

**UNIVERSITY OF WISCONSIN / UNIVERSITY  
OF MINNESOTA**



# Project Executive Committee

Port of Duluth	City of Superior	NOAA
Port of Milwaukee	(municipal vacancy)	U.S. Maritime Administration
Port of Chicago	State of Wisconsin	SLSDC
Port of Indiana	(state vacancy)	SLSMC
Port of Toledo	Great Lakes United	
Port of Cleveland	Great Lakes Commission	
Port of Erie	Fednav	
Port of Toronto	(vessel operator vacancy)	
Port of Hamilton		

# Project Funding

(as of May, 2007)

Great Lakes Ports	100,000.00
U.S. Department of Transportation	900,000.00
Maritime Administration	700,000.00
SLSDC	50,000.00
SLSMC	50,000.00
NOAA	1,250,000.00
GLMRI	50,000.00
Total	3,100,000.00



# GSI Research & Testing Facilities

- **Bench Scale (in laboratory - UWS/UMD)**
  - Residual toxicity
  - Dose response
  - Mechanism
- **Pilot Scale (Montreal pier facility)**
  - Scale effects
  - Ambient conditions/organisms
- **Shipboard (salty operator / CA laker operator)**
  - Ship effects
  - Various ambient conditions/organisms



# World View of Ballast Water Treatment Testing Facilities

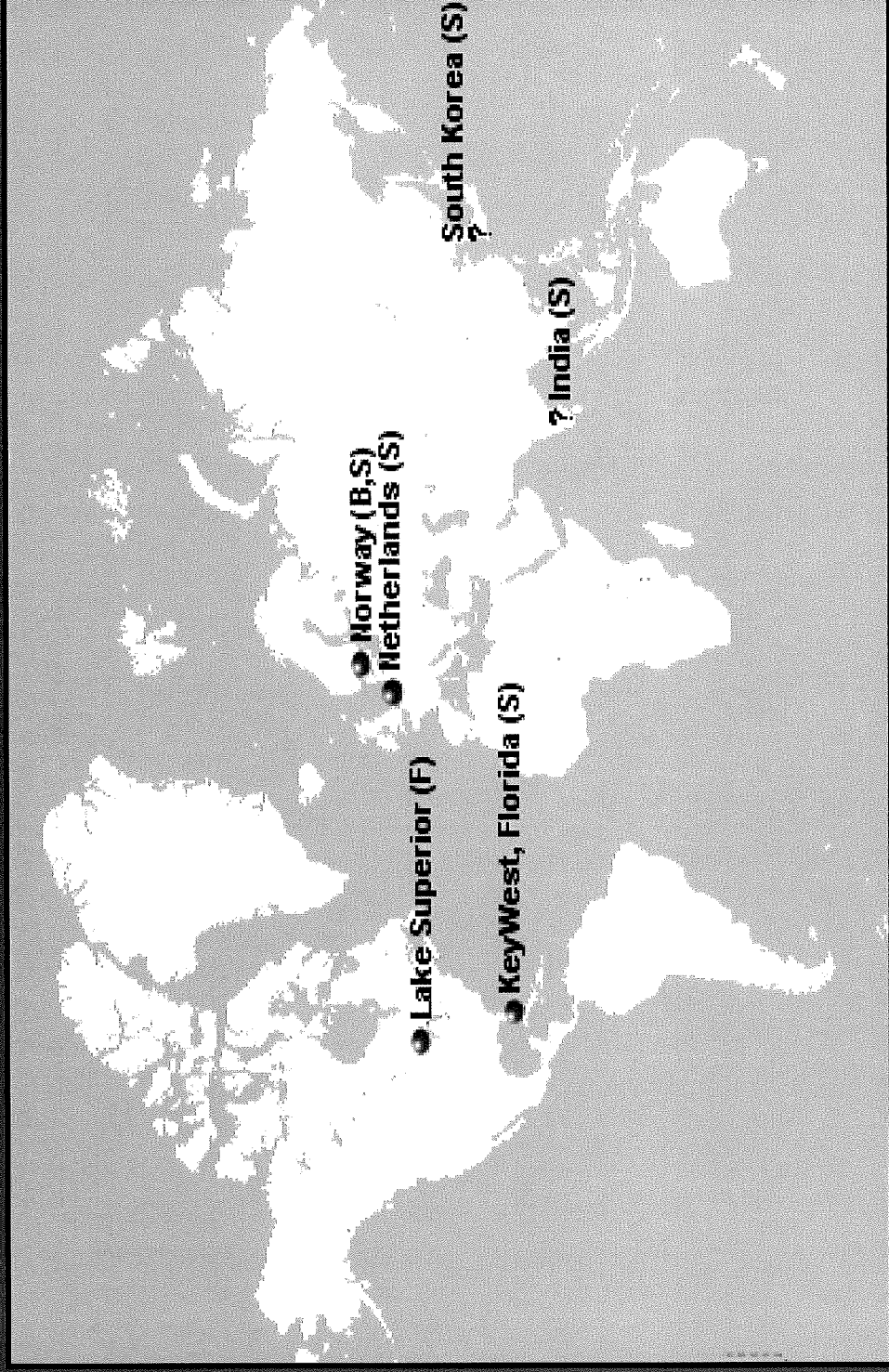



# Examples of Treatment Technologies

Between 30-40 companies around the world are developing ballast water treatment technology



# MicroKill UV system

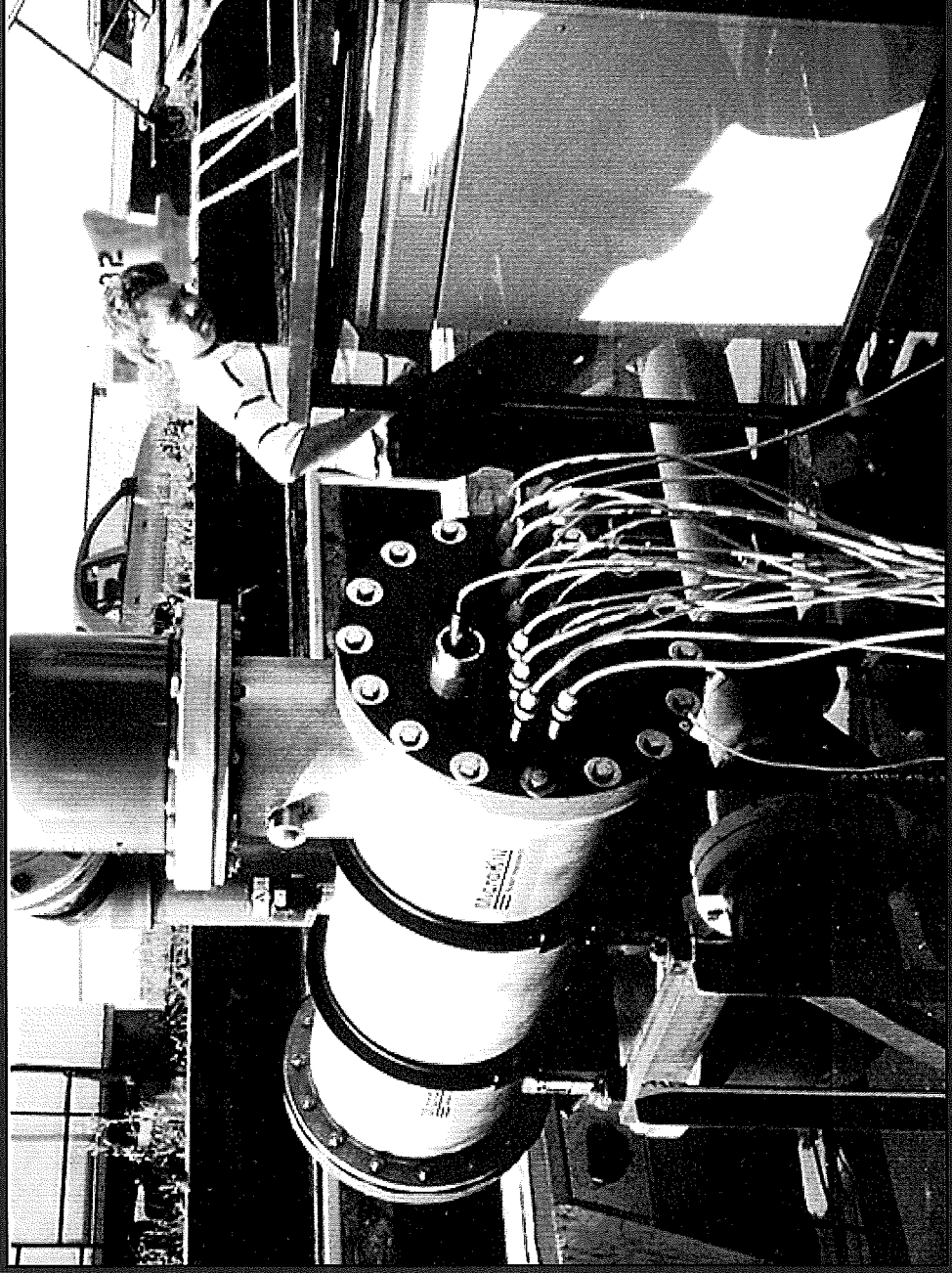



# Hyde Marine's filtration system



# Ecochlor™ ballast water treatment system (chlorine dioxide)

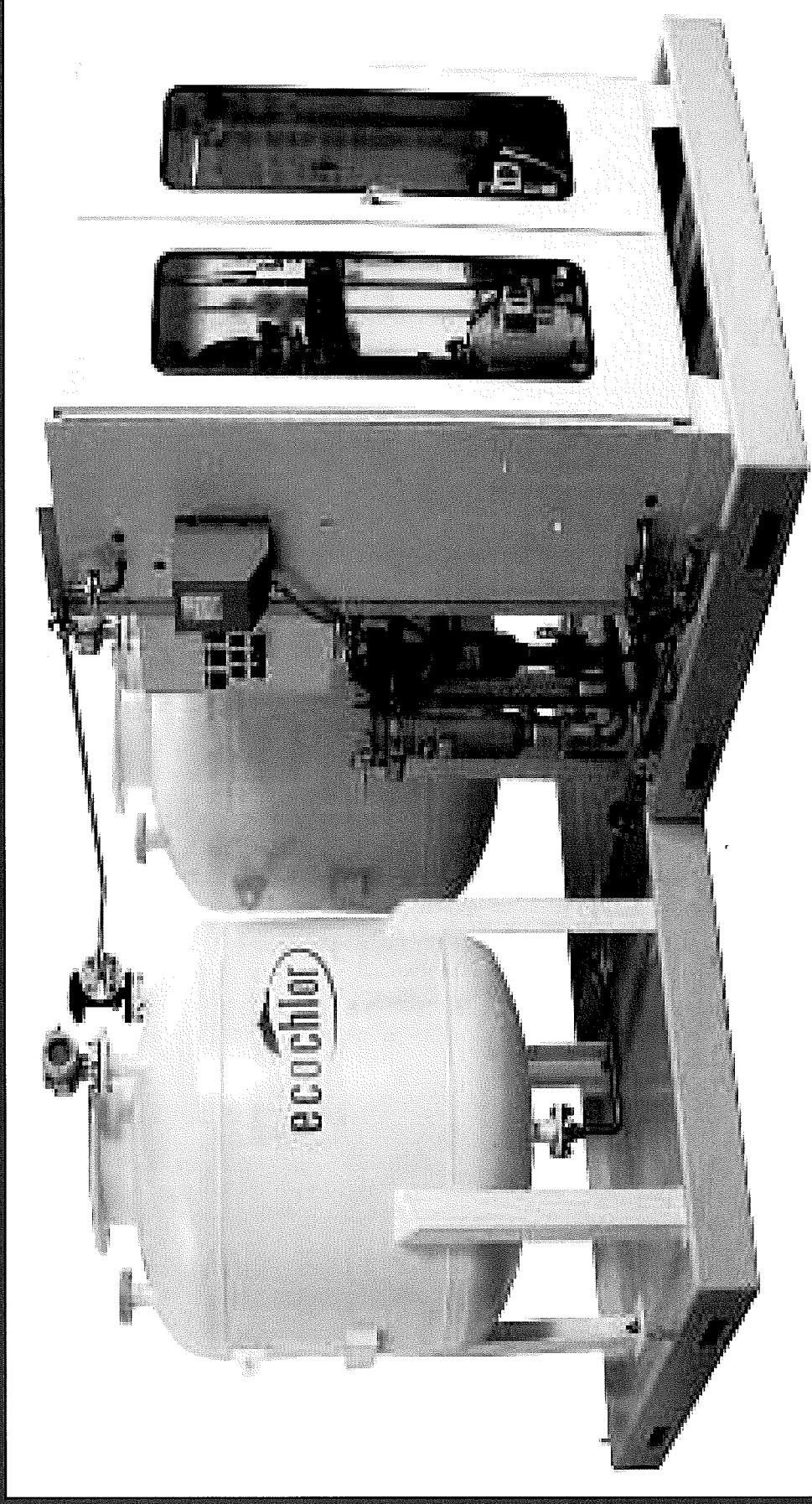



# Aquahabistat deoxygenation system

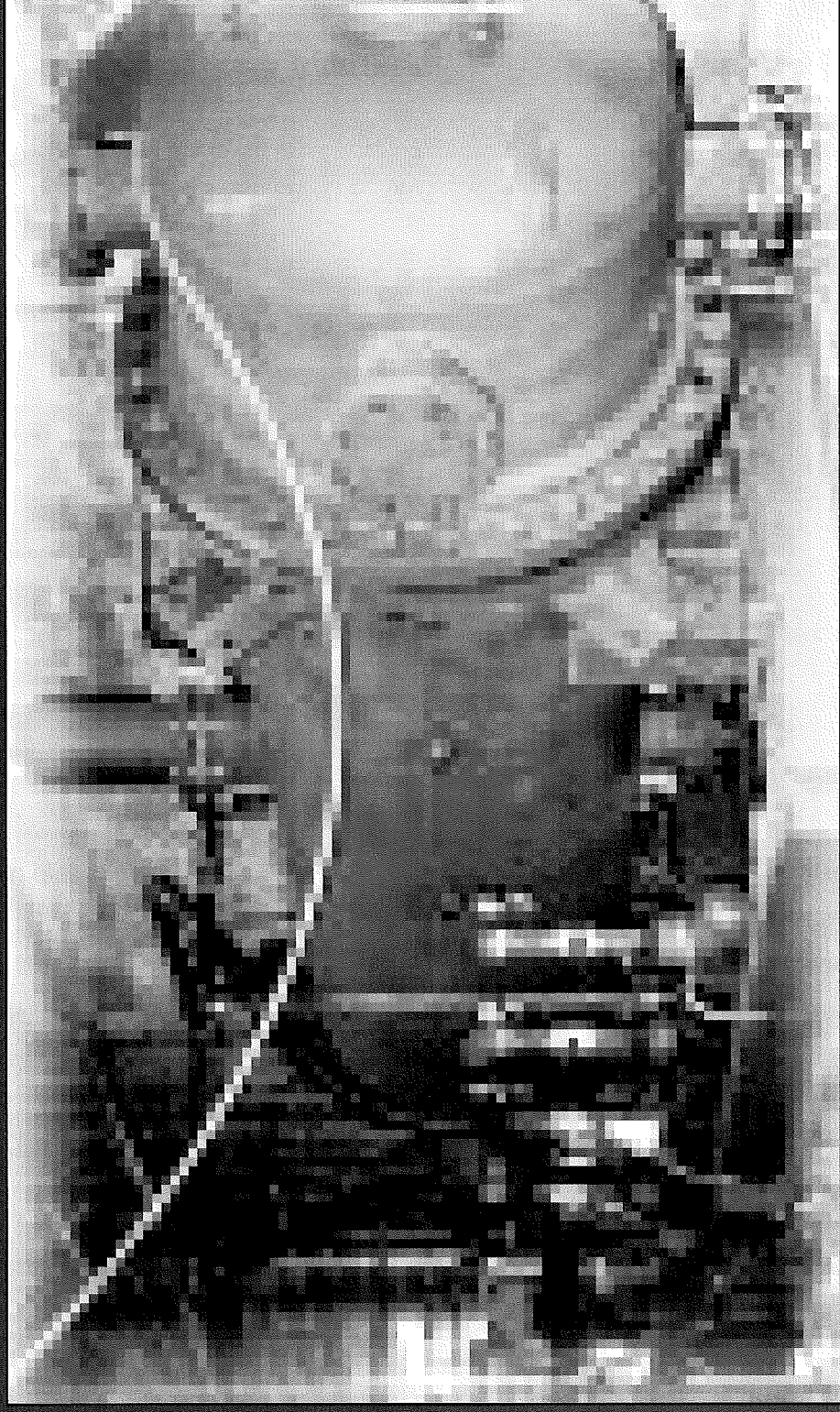



# SEDNA® hydrocyclone by Degussa

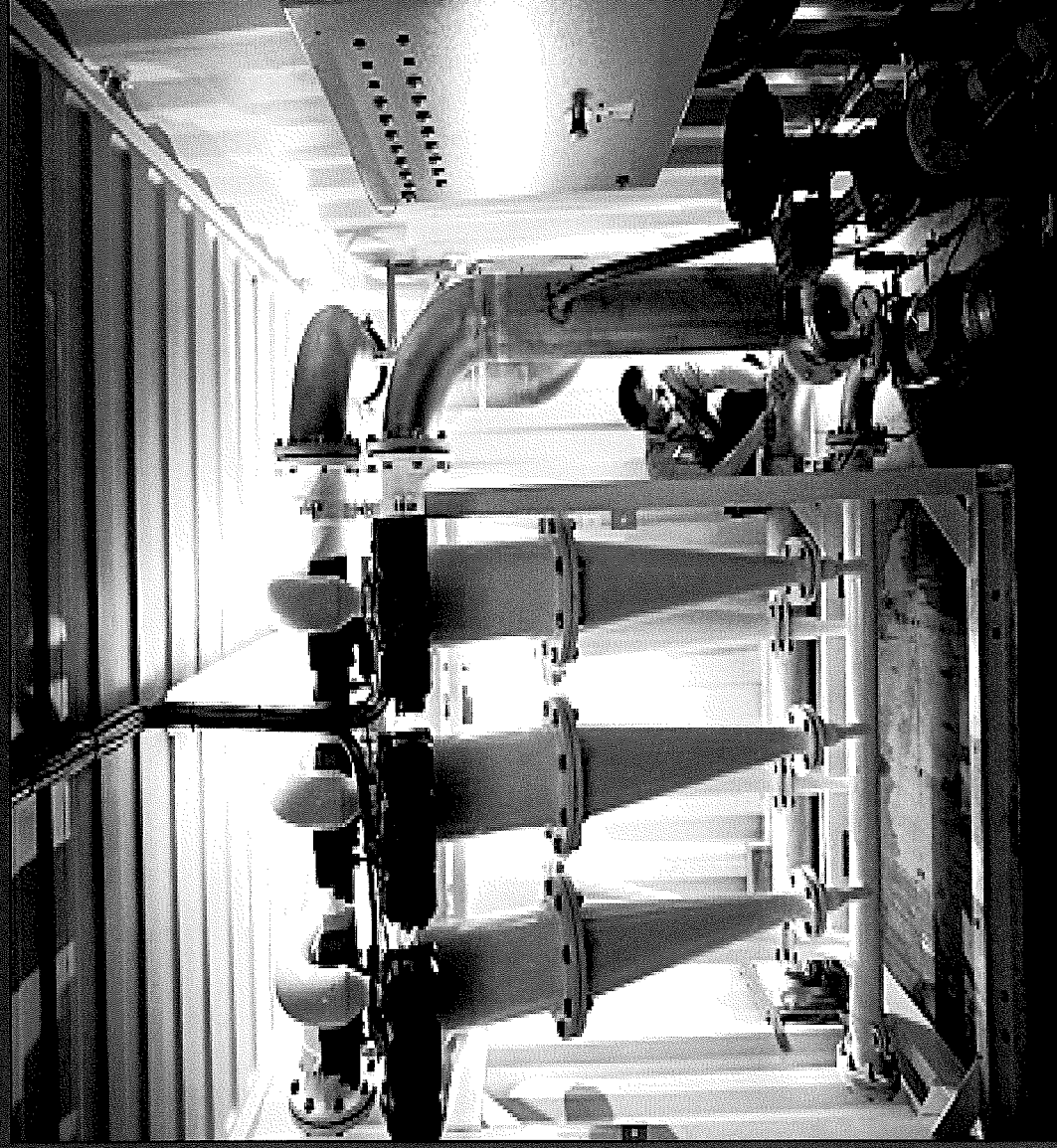



# Treatment Systems

**DO THEY WORK?**

**SAYS WHO?**

**BASED ON WHAT TESTS?**

**PERFORMED IN WHAT MANNER?**

**ACCORDING TO WHAT CRITERIA?**

**CERTIFIED BY WHOM?**



# Why Test?

PROTECT THE PUBLIC  
INTEREST

PROTECT THE PURCHASER  
FROM FRAUD



# Montreal Pier Test Facility

Superior, Wisconsin



# Port of Duluth/Superior





# Montreal Pier Test Facility

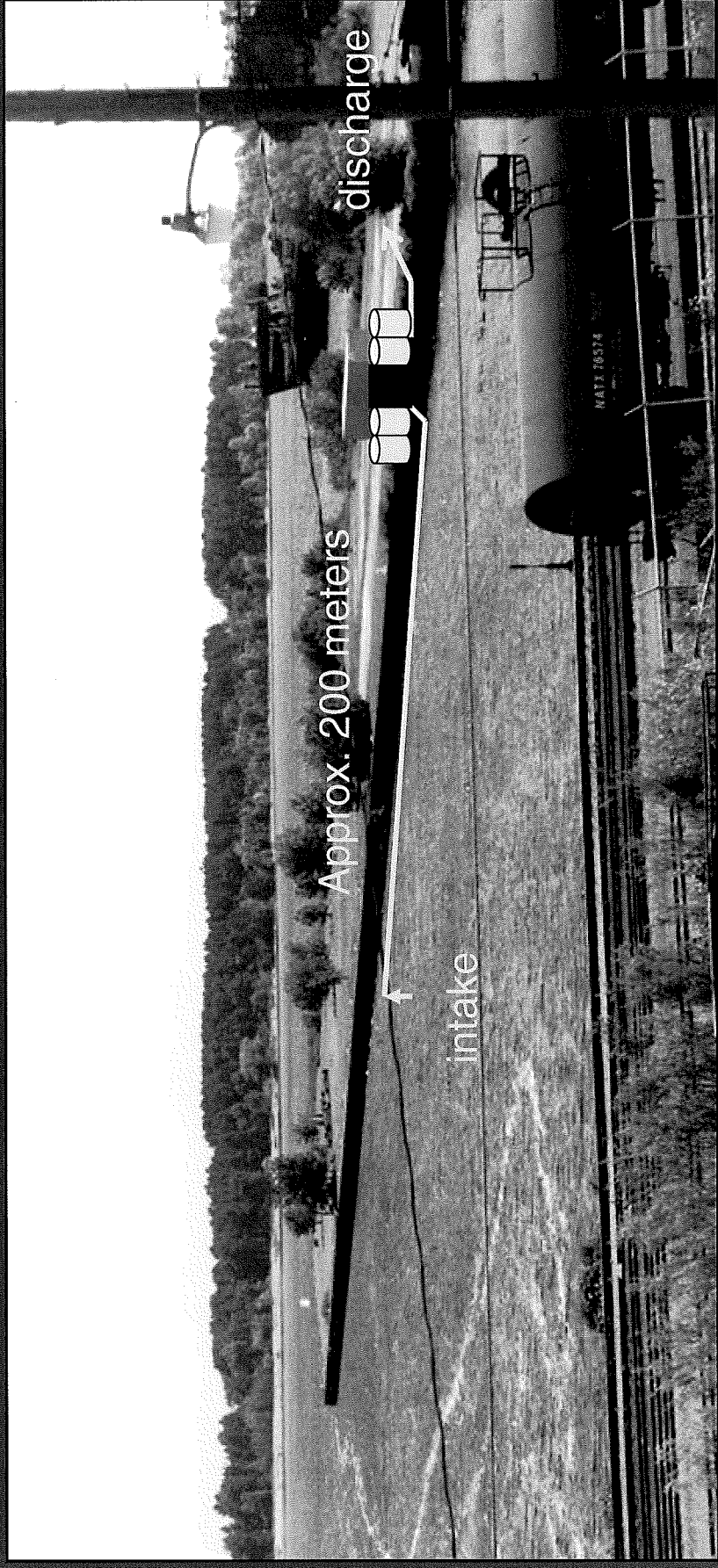



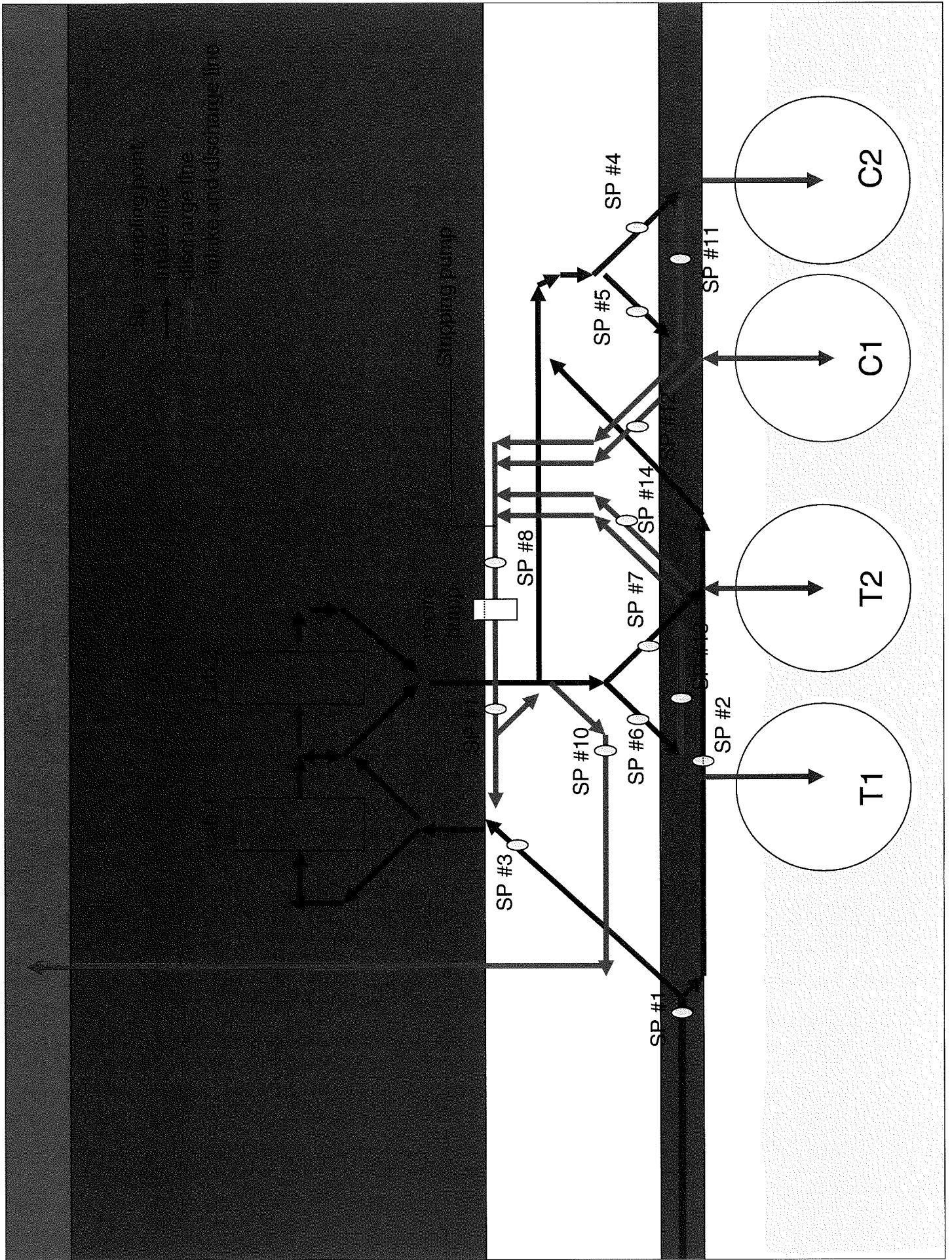



# Set of Four 200 Cu Meter Tanks





# Piping Framework

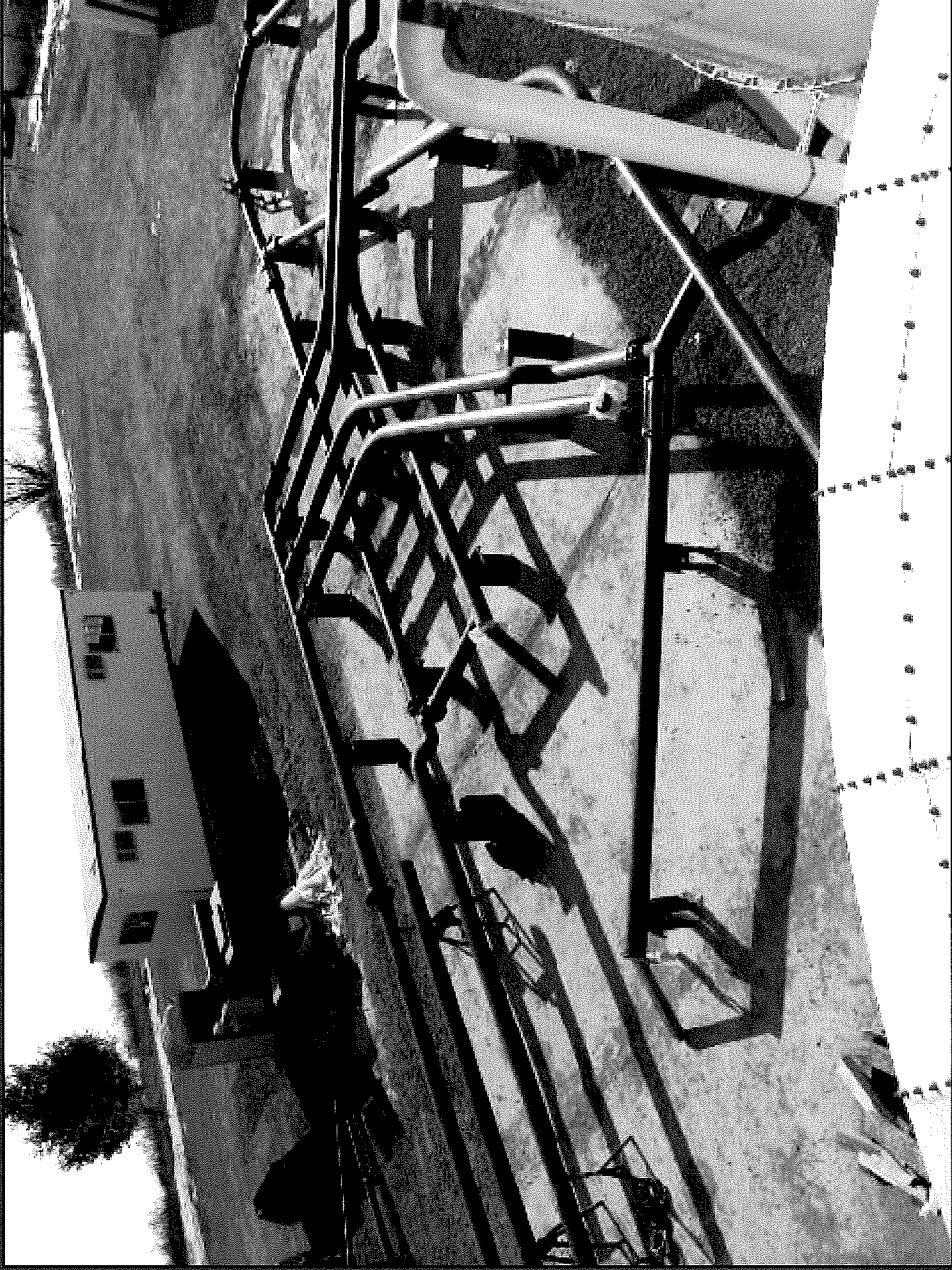



# Valves



Automated Valves

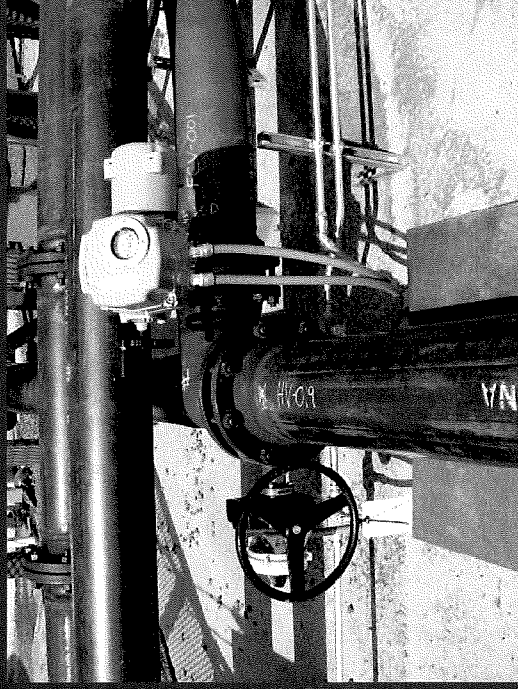

Pressure and Flow Control Valves

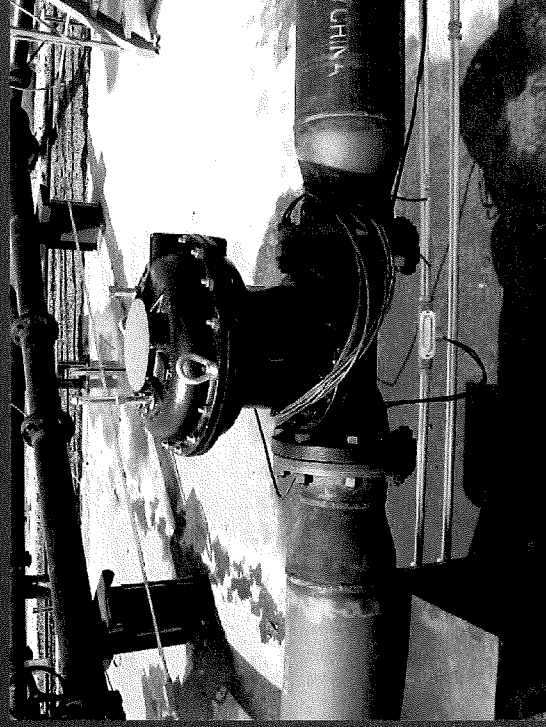

Diaphragm Valve

# Mobile Laboratory Facility

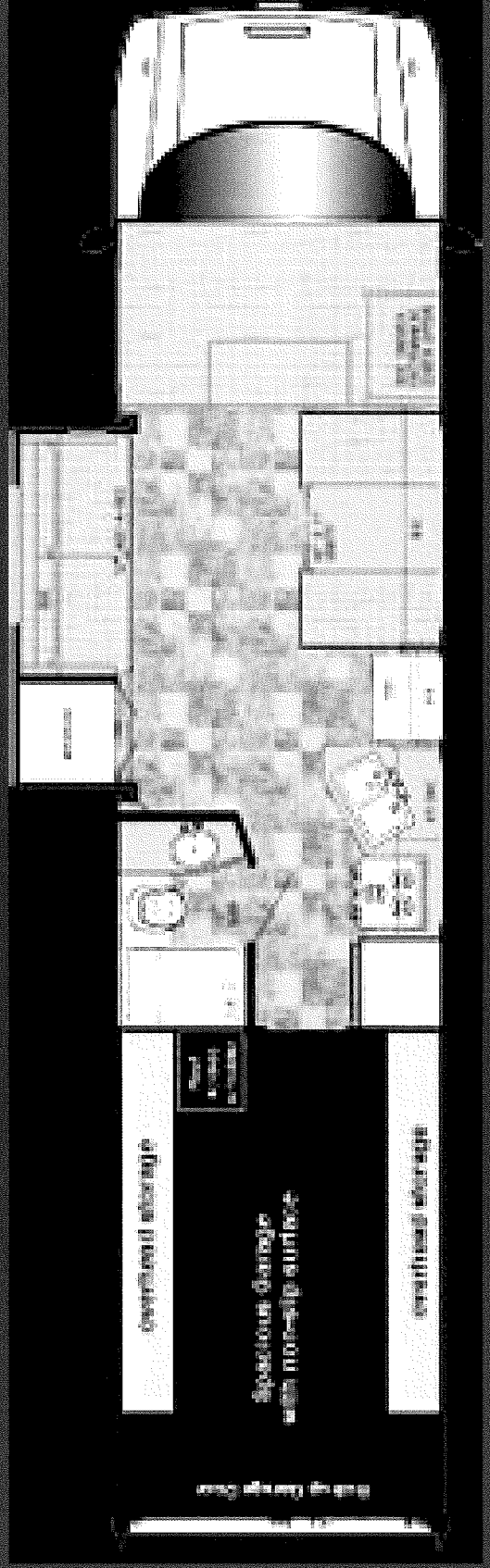
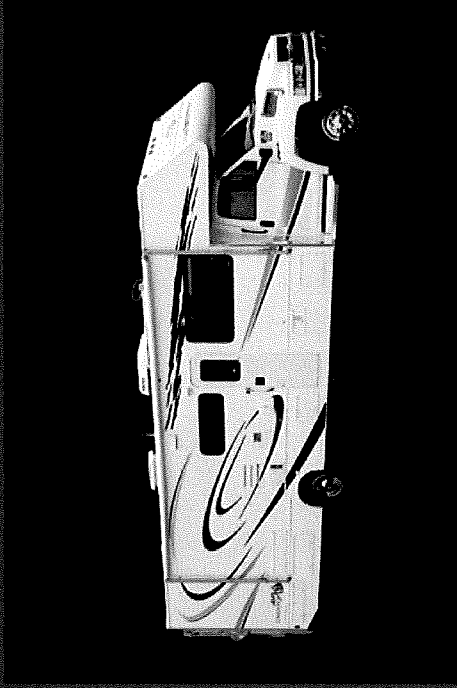



# What's Next?

- Spring 2007
  - Facility Construction Complete
  - Scientific Protocols Complete
- Summer 2007
  - First Solicitation for Treatments to be Tested - VHS
  - Facility Calibrated / Vetted
  - Preliminary Tests
- Fall 2007
  - First Full RFP Issued



**Want to Know More?**

“Great Ships for the Great Lakes”  
GSI Scoping Report

available at:

[www.nemw.org](http://www.nemw.org)